

6. Indoor public spaces

6.5.3 Emergency systems

Location:

Date and time:

Auditor:

Description:

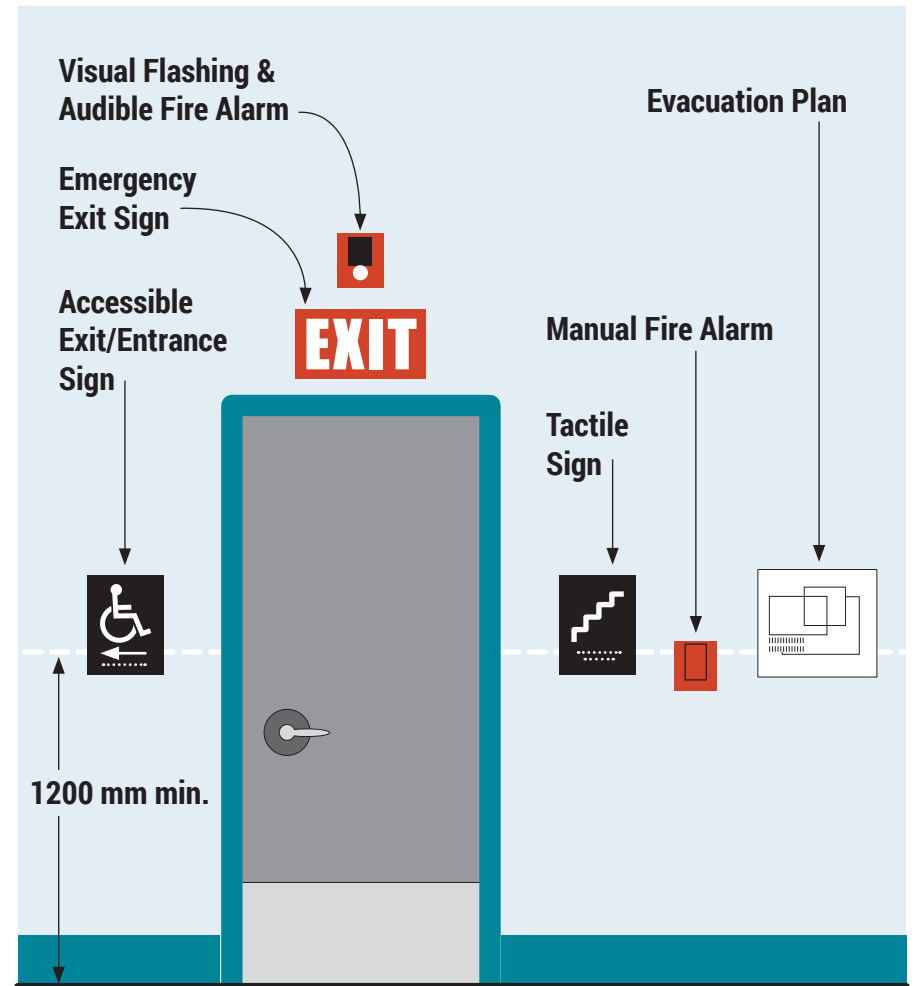

This worksheet applies to fire and life safety systems, addressing the needs of people with varying disabilities in emergency situations.

An evacuation system providing visual and audible fire alarms (6.5.3.a), instructions that address the needs of users with varying disabilities (6.5.3.b), and alarm controls and emergency equipment that is mounted at an accessible height (6.5.3.c.i).

	Source	Yes (+ 3)	Most of the time (+ 2)	Some -times (+ 1)	No (0)	N/A (- 3)*	Comments
6.5.3.a Are visual fire alarms generally visible both throughout the facility and where people might expect to be alone?	RHFAC (7.2.1)						
6.5.3.b EVACUATION INSTRUCTIONS							
6.5.3.b.i Are evacuation instructions posted within 1200 mm (47 in.) of the floor?	RHFAC (7.2.1)						
6.5.3.b.ii Are evacuation instructions both identified by signage and displayed in high contrast, large print (at least 14-point type)?	RHFAC (7.2.1)						
6.5.3.b.iii Is there signage that indicates evacuation plans?	RHFAC (7.2.1)						
6.5.3.c ALARM CONTROLS & EMERGENCY EQUIPMENT							
6.5.3.c.i Are manual fire and emergency alarm controls mounted within 1200 mm (47 in.) of the finished floor?	RHFAC (7.2.1)						

chart continued on next page →

	Source	Yes (+ 3)	Most of the time (+ 2)	Some -times (+ 1)	No (0)	N/A (- 3)*	Comments
6.5.3.c.ii	Is emergency equipment mounted within 900–1100 mm (35–43 in.) of the floor—fire extinguishers, hoses, first aid kits, defibrillators?						
	RHFAC (7.2.1)						
						Subtotal	Max. score
						+ 18	=
		Subtotal	Subtotal	Subtotal	Subtotal	Final Total	
		+	+	+	=		

Principle 1

Does this feature follow the whole journey approach?

Principle 2

Does this feature follow the concepts of universal design?

Principle 3

Is there an adequate seasonal maintenance program for this feature?