

Public Notice – Administrative Application Posted

These documents have been submitted with respect to an administrative aquaculture licence / lease application. The information in these documents is provided as part of the routine disclosure of information by the Department of Fisheries and Aquaculture (the “Department”). Some information may be redacted as business confidential information or personal information.

These documents were provided to the Department by the applicant (with the exception of the attached Schedule “A” which was generated by the Department). The Department is not responsible for the content of these documents, including, but not limited to, the accuracy, reliability, or currency of the information contained within.

Applicant: Vince Stuart	Type of Application: Assignment
Application File Number: AQ#0828	Species: Bay quahog, Bay scallop, Blue mussel, European oyster, Giant sea scallop, Soft-shell clam, Sugar kelp
Location: St. Mary’s Bay, Digby County	Method of Cultivation: Suspended
Application Received On: June 20, 2024	

To learn more about the aquaculture lease and license application process, please visit

<https://novascotia.ca/fish/aquaculture/licensing-leasing/Aqua-Licensing-and-Leasing-Overview.pdf>

Table of Contents (Page 1 starts after this table)	
	Document Page(s)
	Aquaculture Application 1-2
	Schedule “A” (as drafted by the Department) 3-4
	Development Plan 5-26



Office Use Only
Received April 25, 2024 via Email

Aquaculture Assignment Application

Licence/Lease No: 0828

Current licence/lease holder (Assignor):

Applicant: ESTATE OF VINCE STUART Contact Person: JOY STUART

Nova Scotia Registry of Joint Stocks Number: 3074763

Revenue Canada Business Number: [REDACTED]

Telephone No. (Work): N/A (Home): 902-769-8349 (Cell): [REDACTED]

Fax No.: 902-645-2994 E-mail: jpstuart@eastlink.ca

Mailing Address: 8681 Highway #1 PO Box 146
Meteghan Centre NS Postal Code: B0W 2K0

Civic Address: 96 Chemin du Tower Unit 28
Church Point NS Postal Code: B0W 1M0

Proposed licence/lease holder (Assignee):

Applicant: Innovative Fishery Products Inc. Contact Person: Marc Blinn

Nova Scotia Registry of Joint Stocks Number: _____

Revenue Canada Business Number: [REDACTED]

Telephone No. (Work): 902-837-5163 (Home): _____ (Cell): [REDACTED]

Fax No.: 902-837-5165 E-mail: Marc@innovativefishery.com

Mailing Address: Box 125, Belliveau Cove, NS, B0W 1J0
Postal Code: B0W 1J0

Civic Address: 3569 Highway #1 St. Bernard
Postal Code: B0W 1J0

Submit completed applications to: Nova Scotia Department of Fisheries and Aquaculture, Aquaculture Division
1575 Lake Road, Shelburne, NS B0T 1W0
E-mail: aquaculture@novascotia.ca



Office Use Only

Application Materials

A complete application includes the following:

- Assignment fee (payable to Minister of Finance) according to Section 77 of the Aquaculture Licence and Lease Regulations for Nova Scotia made under Section 64, Chapter 25 of the Acts of 1996, *the Fisheries and Coastal Resources Act*
- Application Form
- Development Plan from proposed licence/lease holder (assignee)
- Copy of up-to-date Shareholder’s Registers which sets out the shareholdings of the companies (if applicable) for both the assignee and assignor

Public Notice and Disclosure

As part of the process for deciding on an aquaculture application, the Nova Scotia Department of Fisheries and Aquaculture (“Fisheries and Aquaculture”) will disclose application information to other government bodies, including, if applicable, the Nova Scotia Aquaculture Review Board for use at an adjudicative hearing relating to the application.

In accordance with departmental policy, which seeks to promote public involvement in the process for deciding on aquaculture applications, Fisheries and Aquaculture may disclose application information – not including, however, personal or business confidential information – on the departmental website.

Privacy Statement

The personal and business confidential information collected as part of an aquaculture application will only be used or disclosed by Fisheries and Aquaculture for the purpose of deciding on the application.

All application information collected is subject to the Freedom of Information and Protection of Privacy Act (“FOIPOP”) and will only be used or disclosed in accordance with FOIPOP.

By signing and submitting this form, I acknowledge that I have read, understand, and accept the above statements regarding the collection, use, and disclosure of the information provided on this form.

Signature of Assignor

[Redacted signature]

Date

March 21, 2024

Signature

[Redacted signature]

Date

March 20/2024

Signature of Nova Scotia Department of Fisheries and Aquaculture Designate

[Redacted signature]

Date

April 25, 2024

Submit completed applications to:

Nova Scotia Department of Fisheries and Aquaculture, Aquaculture Division
1575 Lake Road, Shelburne, NS B0T 1W0
E-mail: aquaculture@novascotia.ca

SCHEDULE A



Aquaculture Site 0828

Corner	Latitude	Longitude
1	44° 24' 46.621"	-66° 3' 10.411"
2	44° 24' 43.404"	-66° 2' 57.411"
3	44° 24' 17.640"	-66° 3' 2.607"
4	44° 24' 20.865"	-66° 3' 15.578"
Centre	44° 24' 32.100"	-66° 3' 6.540"

DATUM NAD 83 CSRS UTM Zone 19
The above coordinates are not from a legal survey

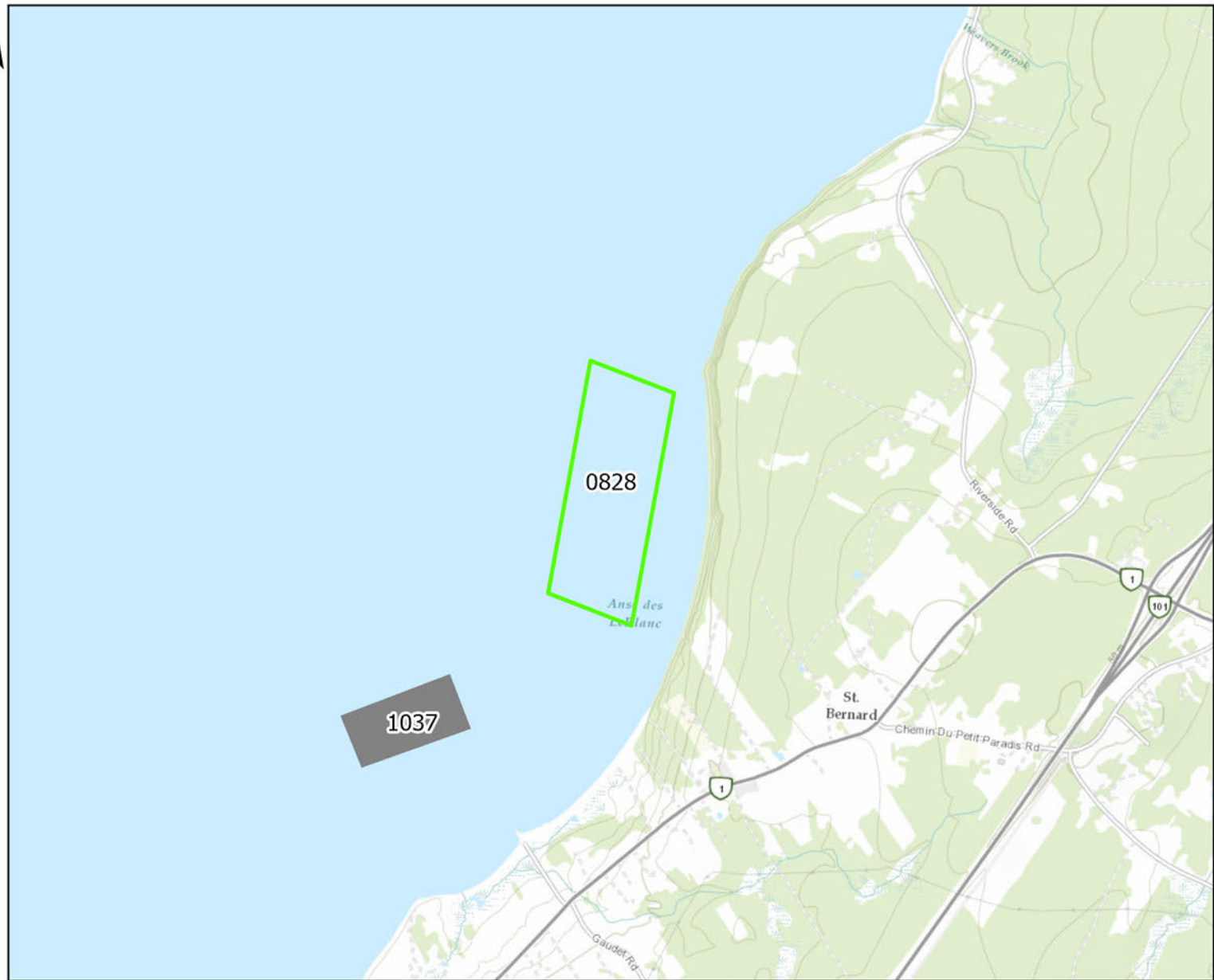

License/Lease Holder	County	Waterbody	Hectares	Species Type	Culture Type	Chart
Estate of Vince Stuart	Digby	St. Marys Bay	24	Shellfish	Suspended Culture	4118

- Assignment Application
- Proposed Lease
- Other Issued Lease

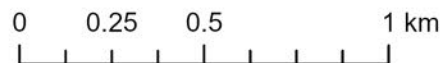

Disclaimer
This map should not be used for navigation
NSDA Page 3 of 26
intended for general reference use only.

Date: 2024-08-30

Created By: MK

SCHEDULE A



Aquaculture Site

0828

Corner	Latitude	Longitude
1	44° 24' 46.621"	-66° 3' 10.411"
2	44° 24' 43.404"	-66° 2' 57.411"
3	44° 24' 17.640"	-66° 3' 2.607"
4	44° 24' 20.865"	-66° 3' 15.578"
Centre	44° 24' 32.100"	-66° 3' 6.540"

DATUM NAD 83 CSRS UTM Zone 19
The above coordinates are not from a legal survey

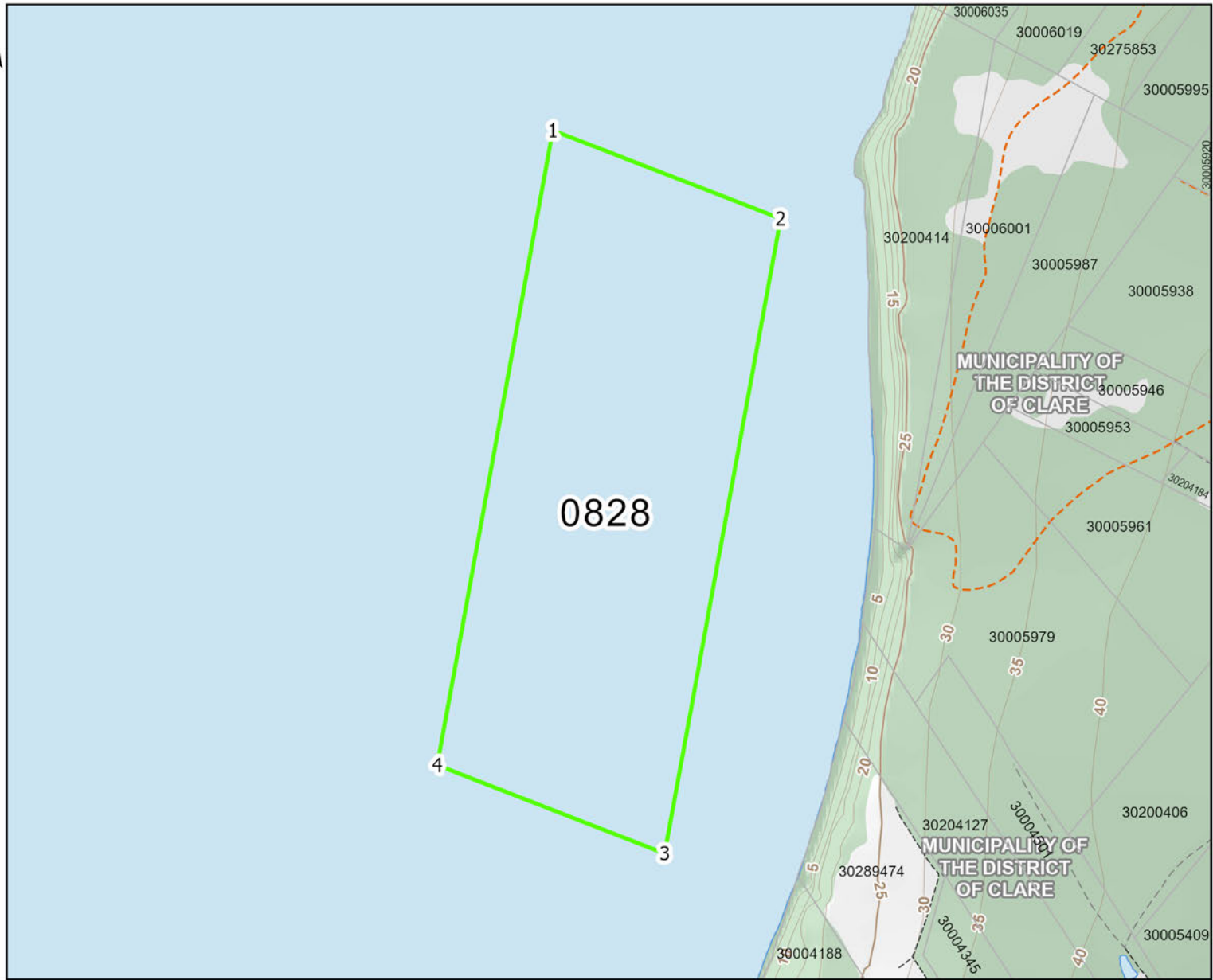

License/Lease Holder	County	Waterbody	Hectares	Species Type	Culture Type	Chart
Estate of Vince Stuart	Digby	St. Marys Bay	24	Shellfish	Suspended Culture	4118

- Assignment Application
- Property Boundary
- Other Issued Lease

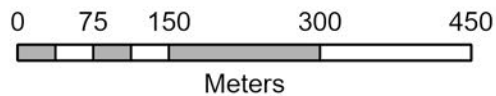

Disclaimer
This map should not be used for navigation or legal purposes. It is intended for general reference use only.
Date: 2024-08-30
Created By: MK

Development Plan

Innovative Fishery Product Inc will be referred to as IFP in this document.

IFP would like to hold the license of 0828 with the intention to use it in conjunction with the hatchery move products from the hatchery to the site and watch to see if transference works. This would be for various stages of the seed and spat. IFP would like to observe at various stages to watch the growth in ocean verses the growth in the Hatchery which has assigned to it the AQ number 1185 and is located on site 3569 Hwy #1 Belliveau Cove, N.S.

IFP would like to keep the size the same as what the site is now, and our amendments would include for this site: We would like to add this *Crassostrea Virginica* (American oyster) , *Spisula solidissima*- (Bar Clam) to this site so that anything that is decided to go in hatchery(1185) it will also be able to go on the site (0828). Therefore, what is on the license for our hatchery 1185 should also be approved for 0828 site. AQ 0828 is in very close proximity to our plants/ hatchery along with a wharf nearby. IFP has done some work on this site in the past. Partnered at that time with Vince Stuart and [REDACTED] Since then, we understand that there has been a trial done for Sugar Kelp. Some of the problems with this site are depth is shallow, Temperature spikes in winter, weather- winds, sea ducks.

IFP's plan is to eventually start the hatchery and use the site as an extension of the hatchery to do various testing and trial of what gear to hold on product. The focus will be to experiment with hardshell (*Mercenaria Mercenaria*) and soft-shell clams (*Mya Arenaria*). Oysters could be of some interest also.

IFP 's reputation of being good stewards of the environment should give us some credit. We work well with DFO Science with the current Beaches that we lease from Nova Scotia Government.

-A) Optimum use of marine resources: IFP's intention for this site is to bring spat from the hatchery and hold on this site for an allocated amount of time to ensure these seed and spat will be able to thrive outside the hatchery. Spat will be taken back inside for holding in tanks. This is a site to Compare and ensure transference works.

B) The contribution of this proposed site to the community and Provincial economic development:

We are strictly at this point looking to ensure the viability of the hatchery.

C) There are no fishery / activities in this area where the site is located as it is too shallow for that to exist. This site is located closest to the Innovative Fishery Hatchery site, and we can see it from our window. It is close to the shore and out of the way for navigation.

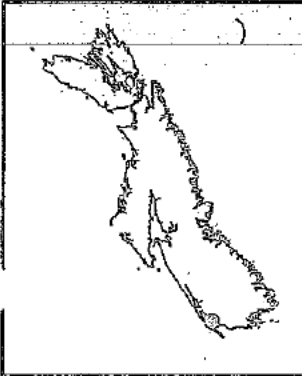

Aquaculture Site
1185

Centre
 Lat 46° 23' 56.86" Long -66° 03' 01.25"

DATUM NAD 83
 The above coordinates
 are not from a legal survey

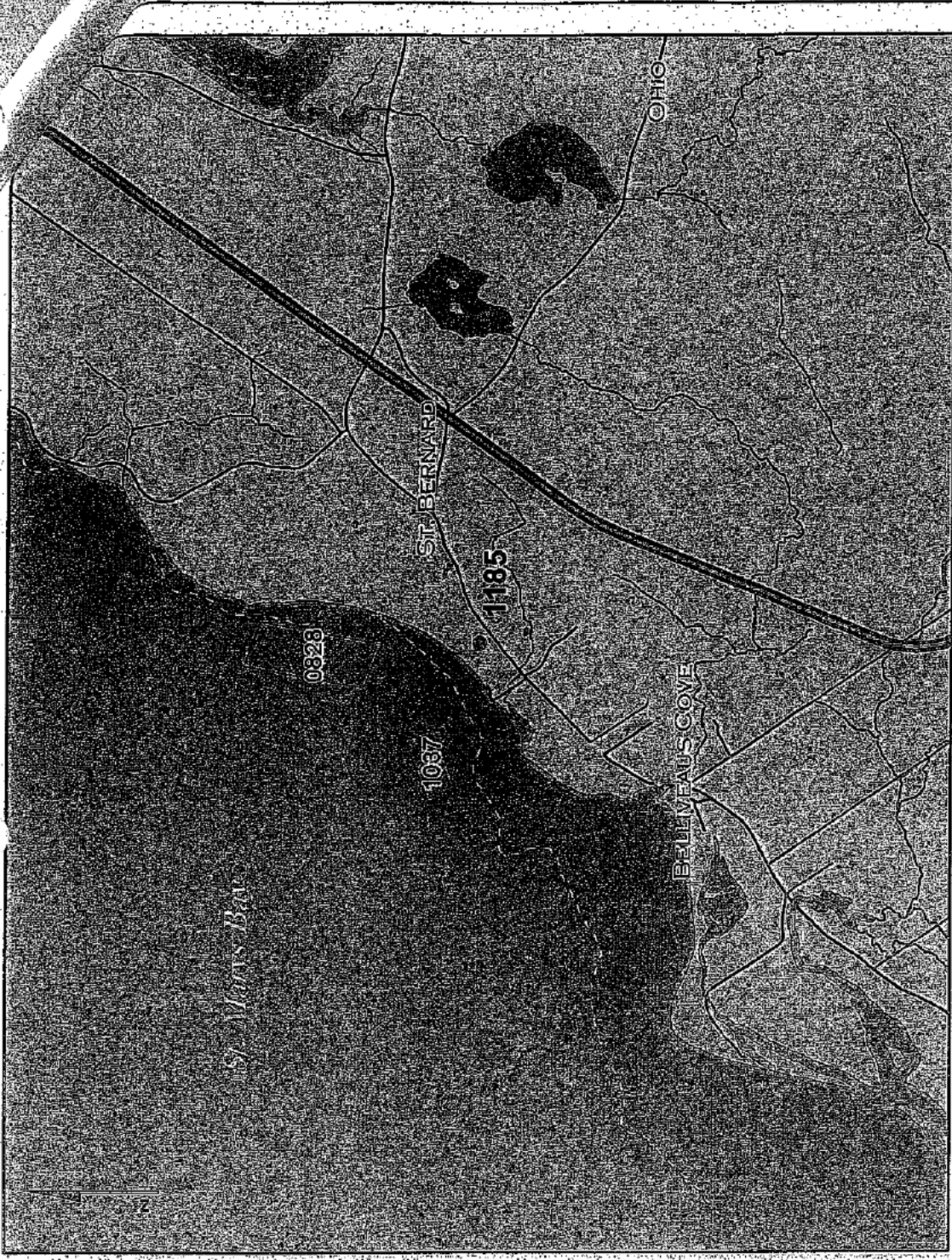

Application Information Proponent : Innovative Fishery Products Inc. Site Location : St. Bernard Dimensions : N/A Area : N/A		Shellfish Hatchery Issued Marine Lease Proposed Marine Lease		OMHW Mark Low Water Mark	
		Chart No. N/A		Signature [Redacted]	
Nova Scotia Fisheries and Aquaculture		Date : OCT 5 2015		Drawn by : Matthew King, June 10, 2015	

Nova Scotia Fisheries and Aquaculture

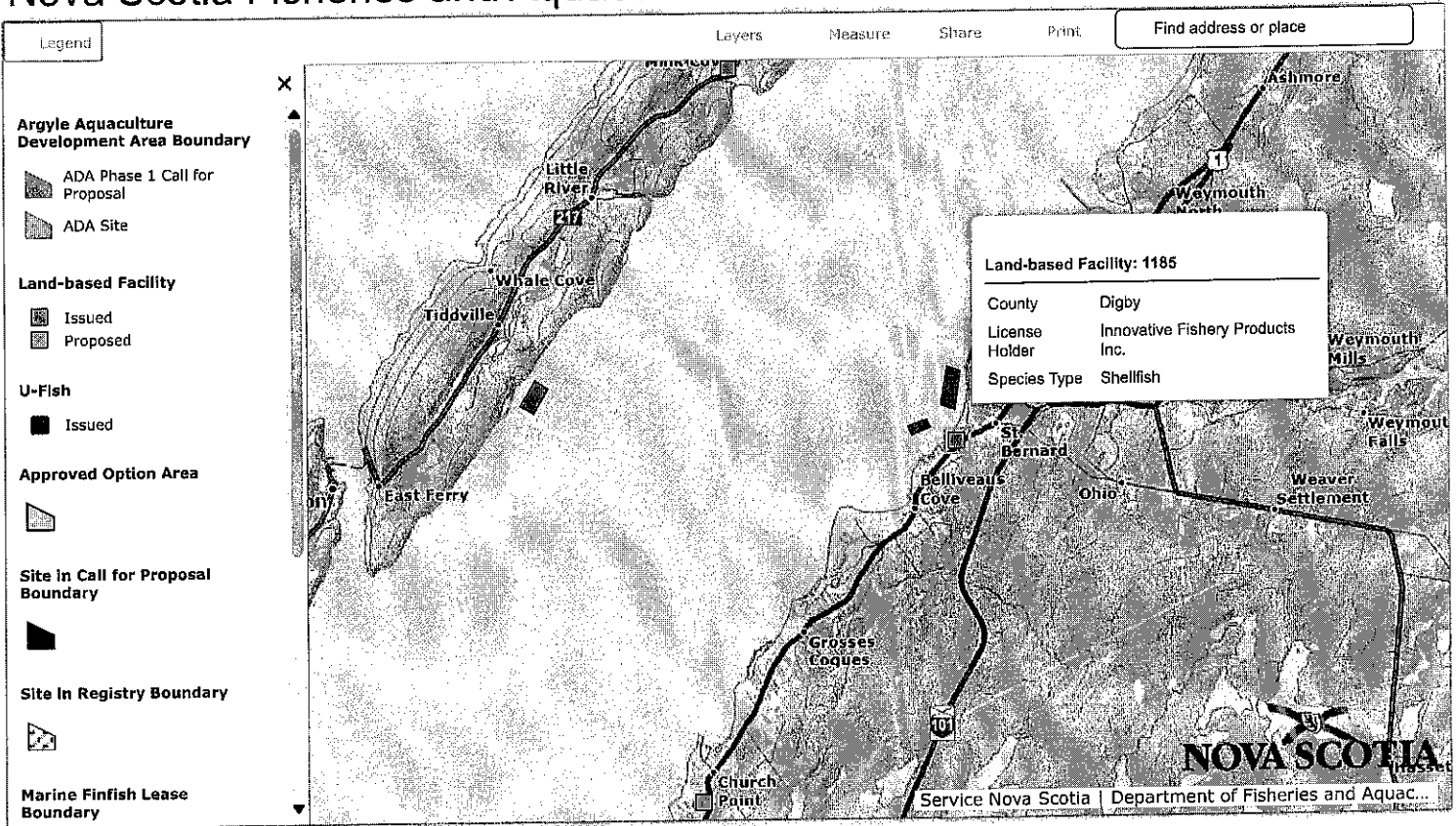

D) Oceanographic and biophysical characteristics of the public waters surrounding the proposed aquaculture operation. ---

There were no anticipated changes identified in the development plan which reflect the oceanographic and biophysical characteristics of the public waters surrounding the existing operation. The history of this site has been suitable and because it is in shallow water and will not be used during the harder months it should not be an issue .

E) The other users of public waters surrounding the proposed aquacultural operation –

The closest site to this site is on the other side of 1185 Hatchery, labeled 1037. The site doesn't seem to be doing anything at this point, however, it is approved for much the same as 0828.

There is a Salmon site in Mink Cove, Little River, Tiddville and East Ferry. All these sites are Salmon or Rainbow Trout Sites, and all are on the opposite side of the Bay. There is one more site for American Oyster. These are on the same side of the Bay but still a good distance away from this site as well.

F) The public right of navigation – this site is not out in the water that far for any right to need to be given. This site is shallow.

G) the sustainability of Wild Salmon –. Bivalves are filter feeders and are known for cleaning the water they live in therefore, there should be no way in which this site should affect the sustainability of Wild Salmon

H) The number and Productivity of other aquaculture sites in the public waters surrounding the proposed aquaculture operation -----

There are 4 sites of Salmon across the bay and 2 sites of oyster on the same side of the bay but further down, closer to the head of the Bay, and the other one right beside 0828.

Productivity of these sites -----

1) Marine Shellfish Lease :1037, Site Status: Issued Commercial, County: Digby, License/ Lease Holder: Paul Belliveau, Marc Belliveau, Bernadette Aymar. Species: European Oyster, Blue Mussel, Sea Scallop, American Oyster, Soft-Shell Clam. Body of Water: St. Mary's Bay, Navigation Chart: 4118 Datum NAD 83 Approximate Heters 7.74, Latitude 44Degrees 24' 6.1888", Longitude - 66degree 3' 36.633".

2) Issued experimental 5008, Bear River First Nations, American Oysters,

Latitude 44degrees 30' 29.506. Longitude

-65 degrees 55' 39.863.

3) Fin fish – Center Point 1449, Proposed Commercial, Canadian Salmon Limited, Atlantic Salmon, Latitude – 44degrees 27' 40.581", Longitude - -66 degrees 4' 52.264".

4) Finfish Center Point 1450, Canadian Salmon Limited, Atlantic Salmon
Latitude 44Degree 26' 9.802" Longitude -66 degree 6 '47.366 "

5) Finfish Center Point 1451, Proposed Commercial, Canadian Salmon Limited, Atlantic Salmon

Latitude- 44 degrees 22' 55.982", Longitude -66degrees 10' 23.351"

6) Finfish Center Point 1452, Proposed Commercial, Canadian Salmon limited, Atlantic Salmon

Latitude- 44 degree 19' 36.495" Longitude - -66 degree 14' 11.053

See Siting Map tool:

(H) Nova Scotia Fisheries and Aquaculture

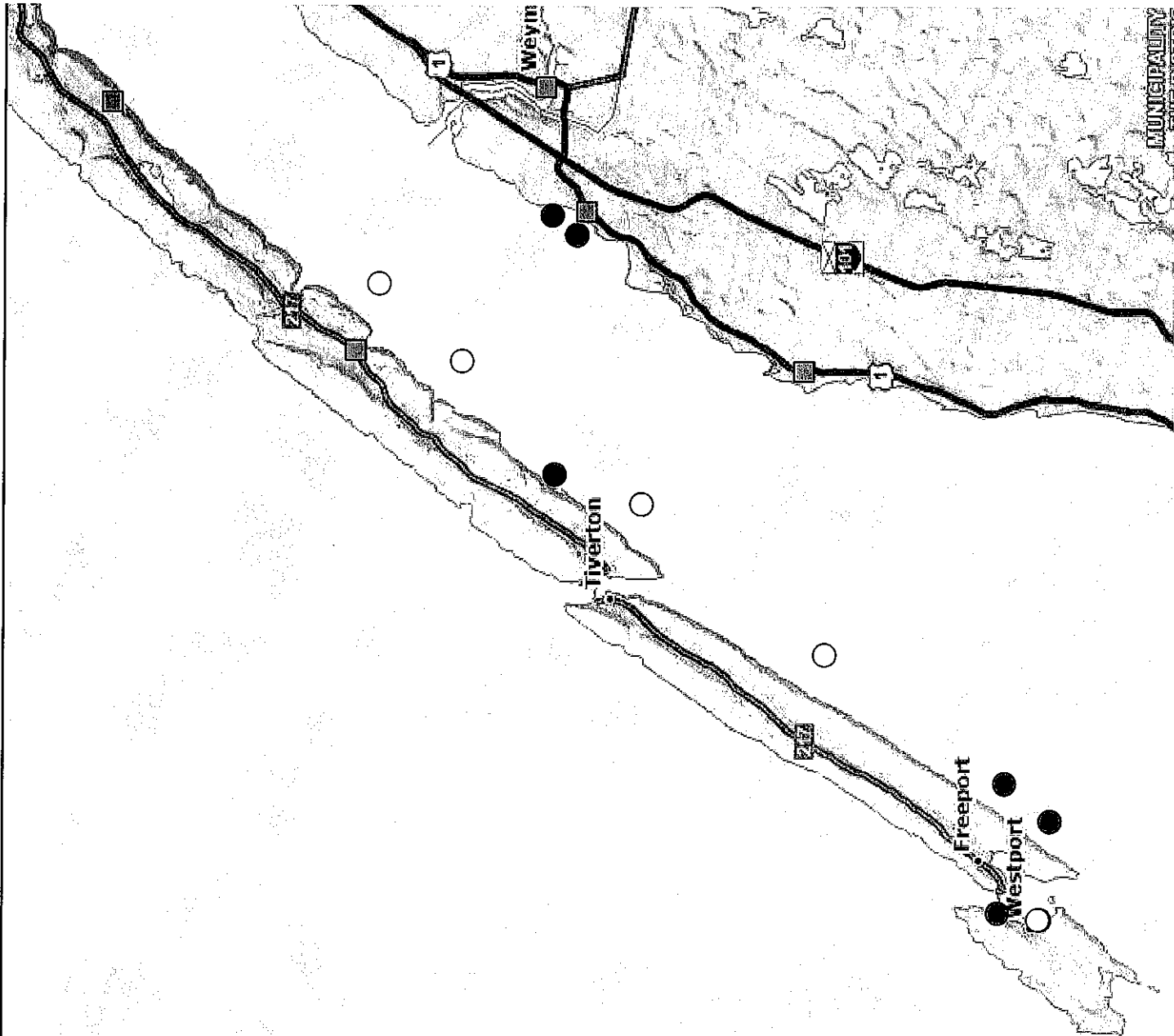

Section #1 THE OPTIMUM USE OF MARINE RESOURCES

Description of this original license and desire changes to license –

Original license information from the map as off the Site Map Tool-

Marine Shellfish Lease – 0828, Site Status: Issued Commercial, County Digby, License/ Lease – Stuart, Vince, Species: Soft Shell Clam, Sea Scallop, European Oyster, Blue Mussel, Bay Quahaug/ (aka Hard-Shell Clam), Sugar Kelp. Body of Water – St. Mary’s Bay, Navigation Chart 4118, Datum NAD 83, Approx Hectares 24.00, Approx: Latitude 44 degrees 24’ 32.137’, Longitude -66 degrees 3’ 6.500 “

The only desired changes at this point to this lease is to add *Crassostrea Virginica* (American oyster), *Spisula solidissima*- (Bar Clam) so it will match up to what we can produce in the Hatchery 1185.

Species: *Mercenaria Mercenaria* (Hard Shell Clam) (aka- Bay Quahaug), *Mya Arenaria* (Soft Shell Clams), *Crassostrea Virginica* (American oyster), *Ostrea Edulus* (European Oyster). (*Siliqua patula*) Razor Clams; (*Spisula solidissima*) Bar/Surf Clam;

Scale: It is IFP “s intention for this site to only use to transfer at various stages to see if a transference works. This will help to make our hatchery viable. We would like to see a comparison between the growth in the Hatchery to the growth in the Ocean.

Technology used: Seed/ Spat is stocked into Mesh bags and deployed in floating cage?

During grow out the stocking densities should be periodically checked and even reduced, if need be, at least checked every 2 Days and seed. This seed instead of being graded will be compared to the equivalent of seed/ spat in the hatchery.

The Location: the location for this site is Approx: Latitude: 44degrees 24’32.137” and Approx Longitude: -66degree 3” 6.500”. and the size is 24 hectares, and the Body of water is St. Mary’s Bay. See also diagrams.

One can see the site would come in handy to use to compare the seed / spat at various stages and ensure a transference works.

This step in the cycle isn’t always required based on the size of the spat being used to be transferred on the site. This system can also be kept and protected inside a building. The difference between both steps is that they can now feed and benefit from the food that is naturally found in ocean and be held in grow bags This would help and assist in knowing the spat can and will thrive when set out to different sites and hence promoting an optimum use of marine resources.

SCHEDULE A



Aquaculture Site

0828

Corner	Latitude	Longitude
1	44° 24' 46.621" N	-66° 3' 10.411" W
2	44° 24' 43.404" N	-66° 2' 57.411" W
3	44° 24' 17.640" N	-66° 3' 2.607" W
4	44° 24' 20.865" N	-66° 3' 15.578" W
Centre	44° 24' 32.100" N	-66° 3' 6.540" W

DATUM NAD 83 CSRS UTM Zone 20
The above coordinates are not from a legal survey

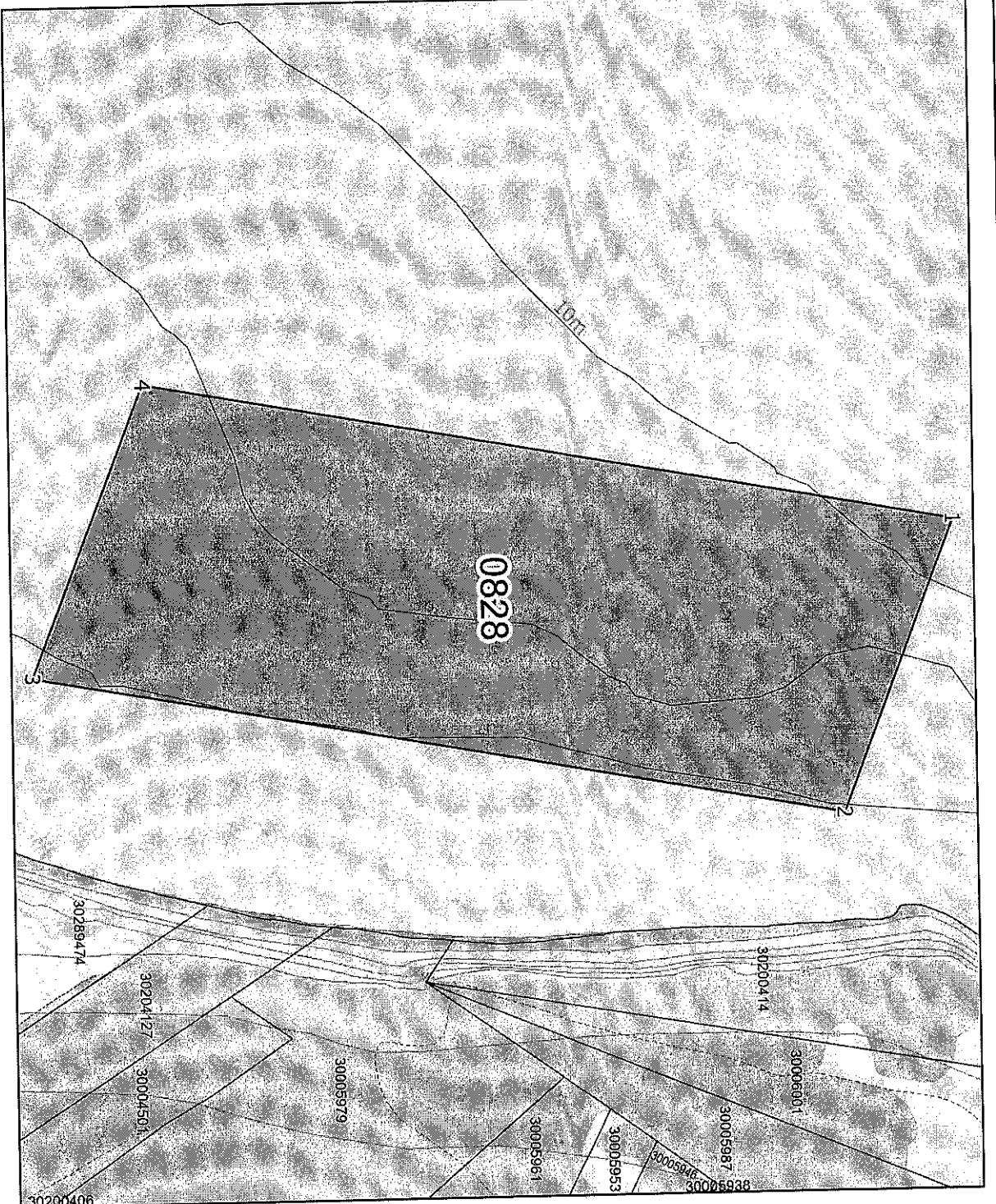

Ref Section #1 Location

License/Lease Holder
Stuart, Vince

County
Digby

Waterbody
St. Marys Bay

Hectares
24

Species Type
Shellfish

Culture Type
Suspended Culture

Chart
4118

Amendment Application

Other Proposed Lease

Other Issued Lease

NS PIDs



Disclaimer
This map should not be used for navigation or legal purposes. It is intended for general reference use only.
Date: 2020-09-05
Created By: MK

Section #2: THE CONTRIBUTION OF THE PROPOSED OPERATION TO THE COMMUNITY AND PROVINCIAL ECONOMIC DEVELOPMENT

- If using suspended method (include spat of seed collections, if applicable):

Species:

Mercenaria Mercenaria (Hard Shell Clam), Mya Arenaria (Soft Shell Clams), Crassostrea Virginica (American oyster), Ostrea Edulus (European Oyster), Spisula Solidissima (Bar Clam). This would be our focus for the time being.

Gear unit type (socks, lanterns, trays, etc.) including dimensions of individual gear units.

The gear for this site IFP will use bagged oysters / clams suspended in floating cages attached to a mainline held in place by anchors, mooring lines, and compensatory buoys. The oyster Gro System consists of a mainline. Lateral lines, Vexar bags and high flow cages in used on the farm, specifications for which are found in Diagram.

Maximum number of gear units.:

Maximum number and lengths of lines:

Shellfish: maximum shellfish introduced (number of mass) and Maximum shellfish on site (number or Mass)

Seed source: Innovative Fishery Inc. Hatchery

Expected time to achieve Maximum production: This would be unforeseen at this point as Innovative Fishery Product Inc is looking for viability before production.

It also needs to be stated that this site will only work for at the most 10 months of the year. From Beginning of March to the beginning or end of November depending on the type of weather we have in the fall, because it is too shallow. Again, only intended for minimal usage for comparability.

As for other species such as soft-shell clams or hard-shell clams there are other ways to do these, but it is quite possible that it could be done this way also. However, harvest for these clams to this point have healthy populations and for the most part the rotation harvesting methods do ensure adequate time for natural rejuvenation and sustainability. IFP has not had to produce seed at the hatchery. The license was renewed in 2020 for a 10-year term.

NOT A SCALE

mm 30 20 10 0
inch

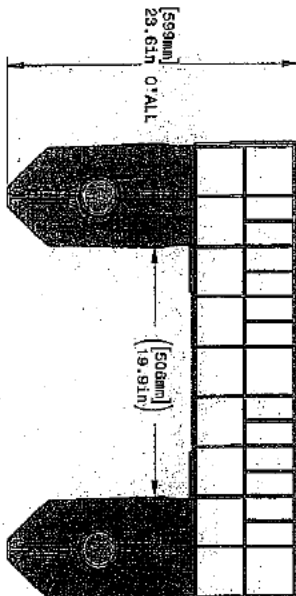
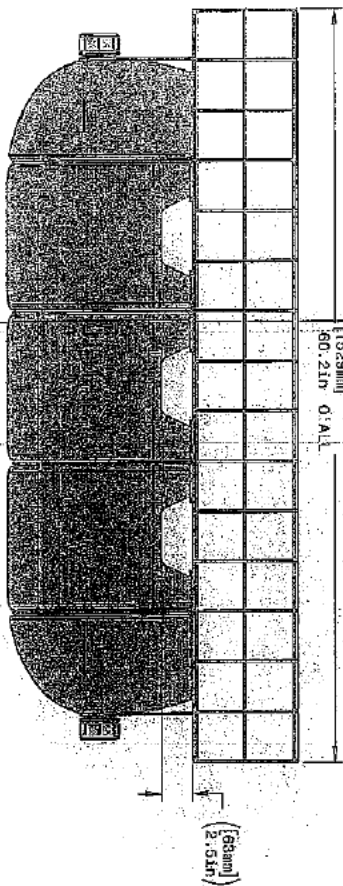
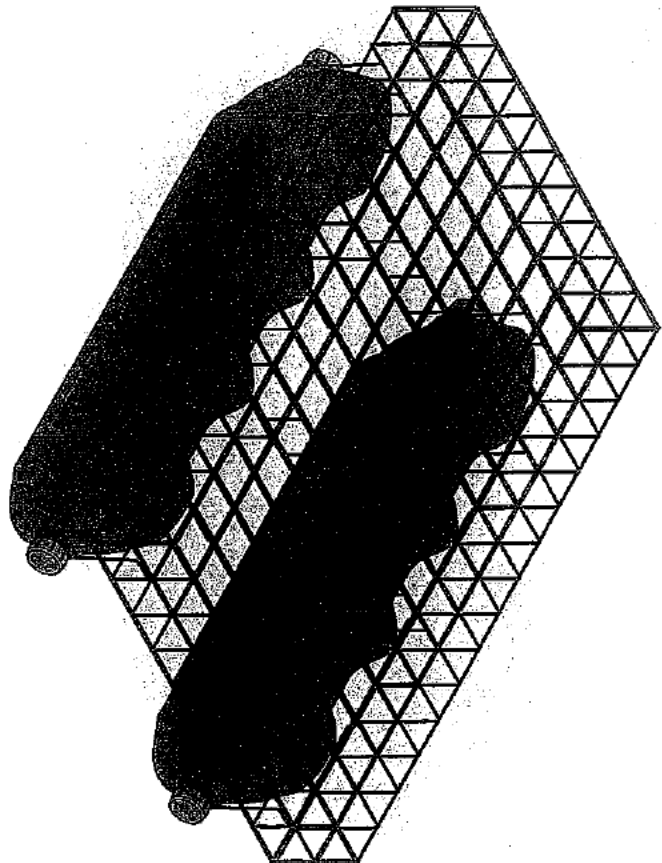
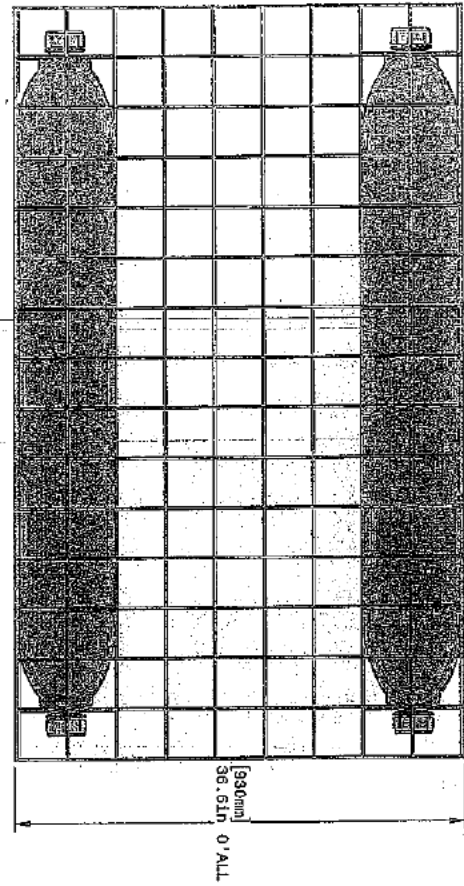

		BOUCTOUCHE BAY INDUSTRIES	
The document may not be used, reproduced or copied without written consent of Bouctouche Bay Industries Ltd. P.O. Box 7182, Bouctouche, NB, E5S 2Z2 Tel: 506.735-5455, Fax: 506.738-6728 Email: info@bouctouche.com			
BOUCTOUCHE BAY INDUSTRIES LTD UNITS: INCHES	BOUCTOUCHE BAY INDUSTRIES LTD UNITS: INCHES	REV: 1 DATE: 01/06/2021 DESCRIPTION: RELEASED FOR REFERENCE	SHEET NO. 1 OF 2 SCALE: NTS
PRODUCT: OYSTERROO CAGE ASSEMBLY HIGH FLO (8 BAGS) CAGE - 4 MESH/ROO	CUSTOMER P/N: HF-42 OPERATED DATE: 12/4/2020	CHECKED BY: [REDACTED]	SHEET NO. 1 OF 2 SCALE: NTS

CAGE

ACCESSORIES - HighFlo - 4"x4" - 8Ga - 2 Mesh High - c/w Shelf & Door with 3 Gator Locks

7/16" Polypro Bridles (Qty 2)

Attaches cage to main line laterals.

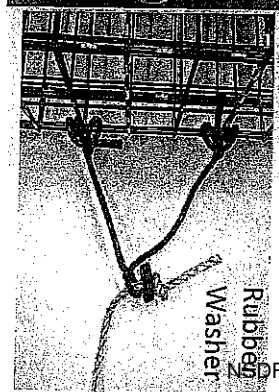
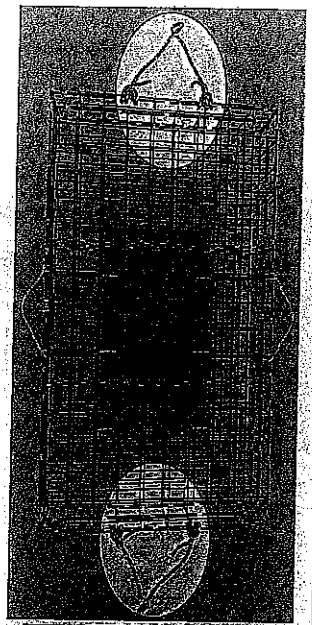

Rubber Washer

1/4" Cord Line Handles (Qty 2)

Rope grabs for ease of handling.

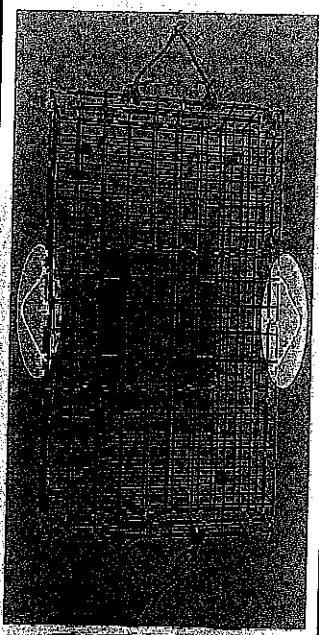

OysterGro Stealth Floats (Qty 2)

Blends into the background.



Also available in Stealth

Different Colored Gator Locks

Visual aid for improved farm management.
(choices of standard Blue & optional Green, White, Yellow and Orange)

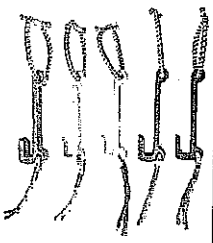

OysterGro® Recommended Line Configuration

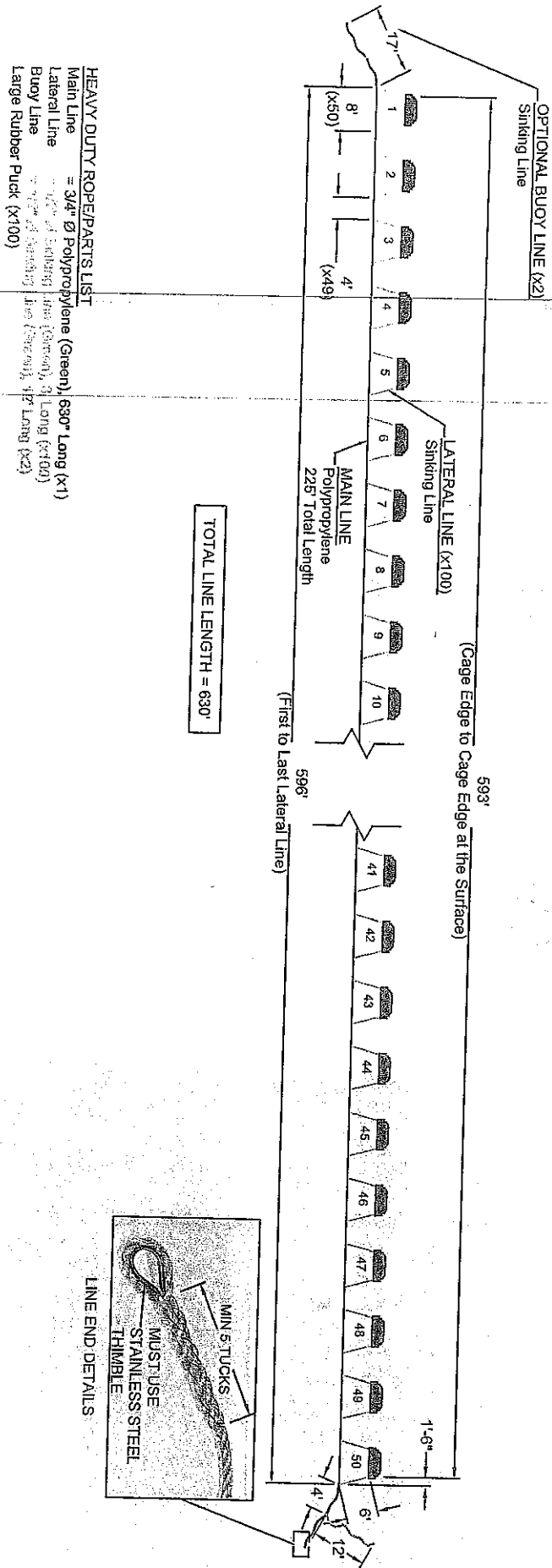

TOTAL LINE LENGTH = 630'

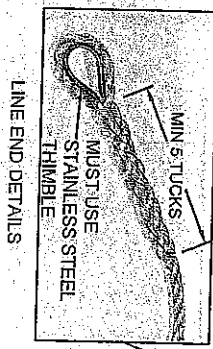

HEAVY DUTY ROPE/PARTS LIST
 Main Line = 3/4" Ø Polypropylene (Green) 630' Long (x1)
 Lateral Line = 1/2" Ø Buoy Line (Green), 31 Long (x100)
 Buoy Line = 1/2" Ø Buoy Line (Green), 12' Long (x2)
 Large Rubber Puck (x100)

REV	DATE (MM/DD/YYYY)	DESCRIPTION
1	02-10-2021	INITIAL RELEASE

PO Box 2182, Bourdeaux, NB E4S 2Z2
 Tel: 506-743-5485 Fax: 506-743-5729
 www.OysterGro.com info@OysterGro.com
 © BBI Group. All Rights Reserved



TITLE	REV
LINE CONFIGURATION - HIGH/LO/PROFLO - OysterGro 6-BAG - 50 CAGES	1
DRAWING NO: LC650STD-6	DRAWN BY: MG
DATE: 02-10-2021	UNITS: FT-IN
SCALE: NTS	SHEET NO: 1 OF 1

Type of Seallex:
SEAFLEX

Option 2

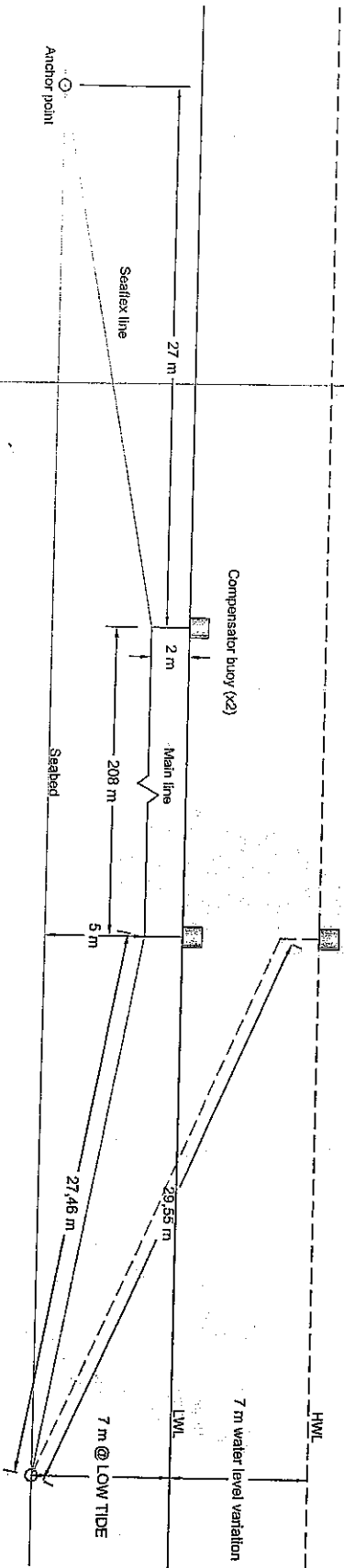

www.seallex.com
Phone: +48 80 96 86 80
Fax: +48 80 15 05 51

OWNERSHIP 17

The use of this document for purposes other than those intended for is prohibited. The user of this document is responsible for its use. No liability is accepted for any damage or loss resulting from the use of this document. Seallex is not responsible for any damage or loss resulting from the use of this document. Seallex is not responsible for any damage or loss resulting from the use of this document.

PRELIMINARY DESIGN

PROJECT: Seallex: Trawl Lho

CLIENT: Dynamic Systems Analysis

Seallex Project Number:	Date:
0719	26/10/2019
Drawn By:	Checked By:
PSK	
Drawing Name:	
Title: Seallex: Trawl Lho, Dynamic Systems Analysis, Seaflex Systems	

Design parameters

Vertical Disturbance (cm)	0.5m
Lateral Water Level	7.5m
Water Level Variation	7.5m
Average Depth of LWL	7.5m
Wave Period (sec)	25 min
Main Trawl Depth	
Deployment Time (min)	1.5h
Current	2.0m

The design is a preliminary design. It is not intended for construction. It is not intended for construction. It is not intended for construction. It is not intended for construction. It is not intended for construction.

SEGMENT	NO. OF SEAFLEX	TYPE OF SEAFLEX
Option 2	2	400T(BIRTH)

Seaflex design

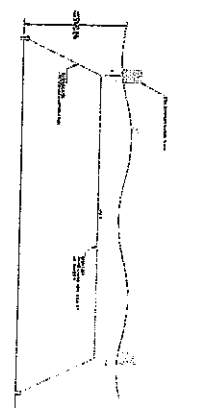

2.2 Infrastructure: Describe any infrastructure additions or changes required to support the request (e.g. buildings, wharves, transportation, onsite equipment, etc.). Include the location(s) of the existing or pending infrastructure to be changed.

No new on-site equipment required.

2.3 Services and supplier: describe service and/or supplier's additions or changes required to support the request, any change in scale of the requirements on an annual basis, and where they will be sourced (i.e. from what region). Include feed, seed, processing, general supplies, and other relevant requirements that may contribute to local or provincial economic activity.

This development Plan will be followed by a Farm Management Plan and will have updates placed in the binder at the beginning of every year to follow. Information that is included in the Farm Management Plan is Environmental Monitoring, Shellfish health and Farm operations.

2.4 Employment: Describe the expected number of direct employees on a yearly basis over the next five years- both local and Provincial, if the request is fulfilled. Break down the allocation according to full time, part time, and seasonal employment. Include types of positions (managerial, technical, administrative, etc.) where possible. Explain how fulfillment of the request will increase employment or improvement or improve the security of employment.

For employment for this at the time would stem from the Hatchery to what degree that it would need to be added more employment would depend on the amount that would be successful. For the time being all minimal employment.

2.5 Other economic contribution to the local community and Province. Describe any other economic spin offs and benefits to the operation if the request is fulfilled – in terms of contributions to the community and the province.

If this goes forward, we will need to hire 2 Biologist full time and 4 support staff to help in the process.

2.6 Adverse economic impacts: If applicable, describe possible adverse impacts on the economic development of the community and the province and how these will mitigate.

Not applicable

Section 3: FISHERIES ACTIVITIES IN PUBLIC WATERS SURROUNDING THE PROPOSED AQUACULTURAL OPERATION.

3.1. Impacts on fisheries activities:

Identify possible changes to impacts on fisheries activities in the public waters surrounding the aquaculture operation (commercial, recreational, food, social and ceremonial) that may occur if the request is fulfilled. Include a description of what measures will be taken in the establishment and execution of the request that: reduce impacts, mitigate risks, and complement or benefit fisheries activities. All fisheries concerns raised during the scoping process (if applicable) should be addressed here.

There should be no concerns about the impact on fisheries activities in the public waters surrounding the aquaculture operation if this request is fulfilled.

Innovative Fishery Products feels at this point it is Not Applicable.

Was also stated in the proposal before this one for Sugar Kelp.

Therefore, it is not applicable.

Section 4: OCEANOGRAPHIC AND BIOPHYSICAL CHARACTERISTICS OF THE PUBLIC WATERS

4.1 Oceanographic environment:

Describe any major events experienced by this site since its development due to oceanographic and biophysical characteristics of the site. (e.g. super-chill incidents, ice damage, storm damage. Etc.).

For shellfish sites, state the location classification.

Classification – is Classified **open area**.

No evidence of oceanographic and biophysical characteristics of this site to this point.

4.2 Environmental Monitoring

Describe how fulfillment of the request may impact the benthic environment. Include what mitigation measures you will employ for expected adverse impacts.

For the intention of this site with the hatchery of IFP there should not be enough out in the ocean to impact the benthic environment of concern.

To this point it would have to be said, not applicable

4.3 Site Design

Describe how the oceanographic and biophysical characteristics of the waters of the location have been accounted for in this request, including past major events described in 4.1 Aspects to be explained could include site configuration, site design, production plan and / or other relevant aspects of the development.

Section #5: THE OTHER USERS OF THE PUBLIC WATERS SURROUNDING THE PROPOSED AQUACULTURAL OPERATION

5.1 Impacts to other users including wildlife:

As said in the last proposal of this site there were other fishery activities in this site there closest to this site is referenced to H) of the first section and the AQ site number 1037 This site would be the Adjacent property owner. There was a performance review at that time, and it did not indicate any adverse impacts on the surrounding public waters.

Also as said before the suspended gear will be set within the geographic boundaries of the site and that is stated in Section 55 of the license and Lease Regulation.

- (1) An aquaculture licence holder must mark each of their sites in a manner determined by the Minister and keep each site marked during the term of their licence.
- (2) An aquaculture licence holder must ensure all the following:
 - (a) that each of their sites is marked as required under subsection (1) before any development takes place at the site.
 - (b) that equipment and aquacultural produce related to any of their sites remain within the geographic boundaries of that site.

Our own Plant is located closest to the site and the site of 1037 however, there has been no indication of any cause for disturbance from the plant or to the plant for water supply as well as offal from the plant.

There is one campground on the same side as this site but, much further down closer to Saulnierville.

Communities (including Cottage communities), Municipal, industrial, and agricultural users which may be sources of effluent, tourism or recreational operations, Private and government wharves, First Nation Territories/ reserves, any known or suspected pre- contact or historic archaeological resources, Important habitats, and conservation areas. Other know potential projects (confirmed or proposed) and activities, other users who are relevant to the area,

All are Not Applicable

Describe how fulfillment of the request may complement to the other users, where applicable

Not Applicable

Concerns raised during the scoping process.

Not applicable

5.2 Impacts by other users including wildlife.

Not applicable

Section 6: **THE PUBLIC RIGHT OF NAVIGATION**

6.1 Navigation Protection Act (NAP) approval –

The assurance of the public right of navigation is determined by Transport Canada through the navigation Protection Act. Changes or additions of, or to, any structure, device, or thing- temporary or permanent- made by humans that is in, on, over, under, through or across any navigable water may require an approval under this act. To determine whether an NPA approval is required, include the following within this section if a change to gear or configuration will be required for the request:

Not applicable

Section 7: **THE SUSTAINABILITY OF WILD SALMON**

7.1 Identification of local Salmon Population

No changes in the stock of wild Salmon. Salmon River is at least 30 mins away on road and possibly more on water and closer to the opening of St. Mary's Bay.

This is quoted from the last lease provisions:

There is no evidence that the amendment to AQ#0828 will have impacts on the sustainability of wild salmon. The information reviewed during the performance review did not indicate adverse impacts on the surrounding public waters. AQ#0828 is authorized to cultivate shellfish using suspended gear, and as such the gear must remain within the geographic boundaries of the site. Section 55 of the Licence and Lease Regulations requires an aquaculture licence holder to mark each of their sites in a manner determined by the Minister and keep each site marked during the term of their licence. Furthermore, AQ#0828 is required to maintain compliance with Transport Canada as it relates to Navigable Waters

Findings and Decision – Amendment Application of Vince Stuart for AQ#0828

March 12, 2021

7.2 Support of the sustainability of wild Salmon

Not applicable

There is no need for this currently. Supplies are sufficient.

SECTION 8: THE NUMBER AND PRODUCTIVITY OF OTHER AQUACULTURE SITES IN
THE PUBLIC WATERS SURROUNDING THE PROPOSED AQUACULTURAL LOCATION

8.1 Interactions with other aquaculture operations.

The only close enough would be 1037 and is still a distance away from 0828. Also, this is a trial for our hatchery and there will not be many products placed here.

Section 9: DEVELOPMENT VIABILITY

9.1 Financial ability –

Describe proof of financial viability of the request. This may include historical and projected financial resources for this development: historical Income Statements including revenues, expenses, and EBITDA for the past three years (if applicable) and one projected production cycle forward. This could also include strategic relationships that can assist with the viability of the proposed development: or other relevant information to demonstrate the financial ability to execute the proposed development.

Not applicable:

We are only looking for viability from the hatchery.: IFP's intention for this site is to bring spat from the hatchery and hold on this site for an allocated amount of time to ensure these seed and spat will be able to thrive outside the hatchery. Spat will be taken back inside for holding in tanks. This is a site to Compare and ensure transference works.

9.2 Technical ability

Describe changes or additions to the technical ability that will be required to ensure viability of the operation if the request is granted. Describe how these will be accommodated. This can include information on the applicant, management, and technical team (if known) in terms of following:

Education

Business experience

Aquaculture experience

Other relevant information demonstrates the human resource ability to execute the proposed request.

Not applicable:

9.3 Compliance history

Describe your record of compliance history. Describe your record of compliance in previous aquaculture operations or in other operations that required management and monitoring of environmental effects.

List any enforcement issues of the past and explain how they were resolved.

Not applicable.