

AR 2012 - 123



Assessment Report

Annapolis Properties Corporation

Brookfield Mines  
Queens County  
Nova Scotia  
Canada

Exploration Licence

09752

DNRMP AUG20'12 15:46



Assessment Report

Annapolis Properties Corporation

Brookfield Mines  
Halifax County  
Nova Scotia  
Canada

Exploration Licence

09752

*Prepared by:  
Drew Pelley  
Tyler Compton  
Adam Sherry*

A handwritten signature in black ink, appearing to read "Drew Pelley", is written over a horizontal line. The signature is fluid and cursive.

## Summary

This report documents work completed in 2012 with respect to exploration licence 09752, located near Brookfield Mines, held by Annapolis Properties Corporation. The property is located, approximately 35 km west of Bridgewater in Queens County, Nova Scotia. This report was written to comply with provisions within the Mineral Resources Act concerning reporting of work on exploration claims. The report covers 12 months of work and expenditures related to exploration of this property.

In the spring of 2012, Annapolis carried out a field program on licence 09752. The program consisted of collecting several rock samples around areas of historic mine workings. In total 9 samples were collected representing altered slate and quartz vein material. The analytical results for these samples indicate anomalous levels of gold in several samples with nearly all of the samples returning values above the analytical detection limit.

## Table of Contents

<b>1.0 Introduction.....</b>	<b>1</b>
<b>2.0 Location and Access .....</b>	<b>1</b>
<b>3.0 Licence Tabulation .....</b>	<b>4</b>
<b>4.0 Climate and Physiography.....</b>	<b>4</b>
<b>5.0 Previous Work .....</b>	<b>4</b>
<b>6.0 Regional Geology .....</b>	<b>8</b>
6.1 Goldenville Group.....	8
6.2 Halifax Group.....	8
<b>7.0 Property Geology .....</b>	<b>9</b>
<b>8.0 Work Performed.....</b>	<b>11</b>
8.1 Rock Sampling.....	11
<b>9.0 Discussion .....</b>	<b>12</b>
<b>10.0 Recommendations.....</b>	<b>12</b>
<b>11.0 References Cited and Selected References .....</b>	<b>13</b>
<b>Appendix I: Statement of Qualifications .....</b>	<b>15</b>
<b>Appendix II: List of Personnel .....</b>	<b>16</b>
<b>Appendix III: Original Laboratory Certificates.....</b>	<b>17</b>

### List of Figures

**Figure 1:** Geographic Map of Nova Scotia showing the approximate property location.

**Figure 2:** Detailed property location map.

**Figure 3:** Rock Sample Location Map

### List of Tables

**Table 1:** Claims tabulation for licence 09752 Brookfield Mines.

**Table 2:** Descriptions and assay results for rock samples.

## 1.0 Introduction

The following report was written to comply with provisions within the Mineral Resources Act concerning the reporting of work on exploration claims. Licence 09752 is composed of 21 mineral exploration claims located about 35 km west of the Bridgewater. This report covers 12 months of work and expenditures related to the exploration of this property.

The property held under 09752 represents the peripheral portion of the North Brookfield deposit. Although 09752 contains some areas where historic mining took place, the majority of historic work occurred on the central licences, currently held by prospector Scott Grant. Previous mining on the property consisted of small scale operations focused on exploiting thin high grade ore shoots. However, recent studies have suggested that altered metasandstone wall rock adjacent to the hinge of the Brookfield Anticline may be auriferous. As a result Annapolis is currently evaluating the North Brookfield deposit for a potential for a low-grade bulk minable deposit.

In 2012, Annapolis carried out a brief field program which consisted of the collection of a number of rock samples. Field staff traversed licence 09752 in the area of the Brookfield Anticline. Samples were collected from glacial drift and from cobbling piles adjacent to historic mine workings. Of the nine samples collected only one contained gold levels below the analytical detection limit.

## 2.0 Location and Access

Annapolis' Brookfield property is located approximately 35 kilometers west of Bridgewater, in Queens County (Fig. 1). The property is accessible via Highway 208 which runs northeast through the property from North Brookfield. Numerous old mining roads and former railway beds provide excellent access. Figure 2 highlights the main road access routes to the property. The claims are situated on NTS Map 21A7C.

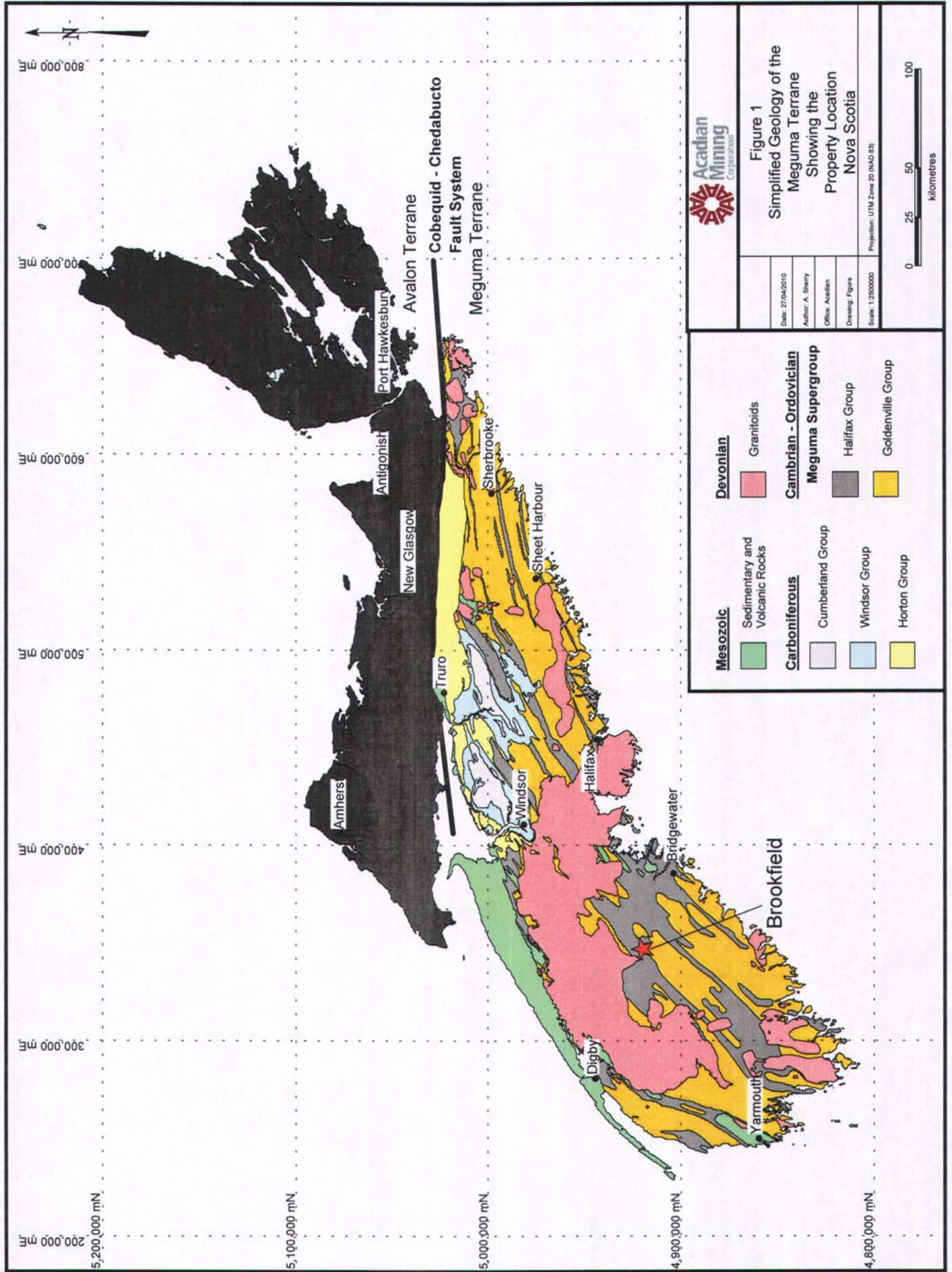
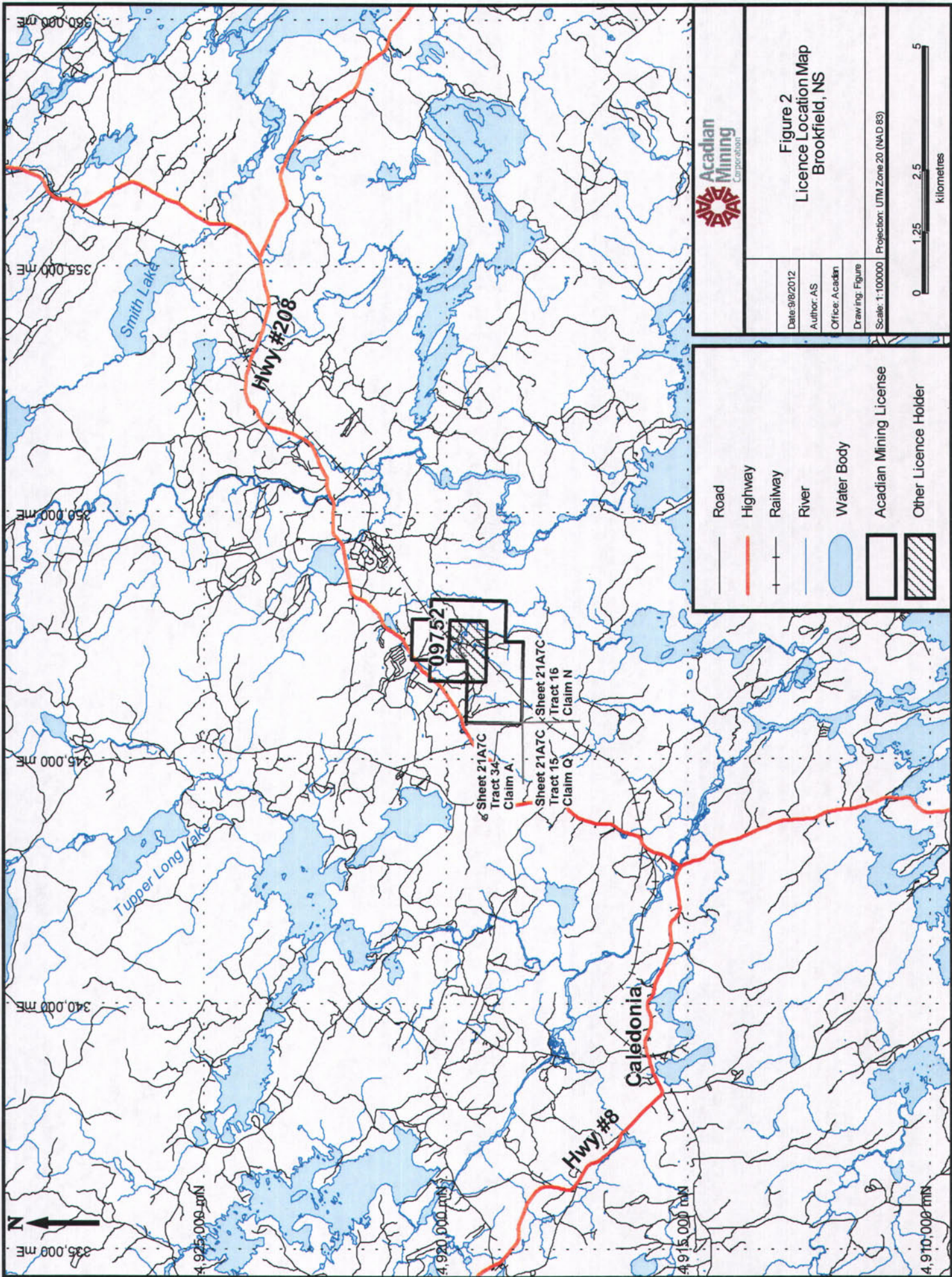

**Figure 1**  
 Simplified Geology of the  
 Meguma Terrane  
 Showing the  
 Property Location  
 Nova Scotia

Date: 27/04/2010  
 Author: A. Sherry  
 Office: Acadian  
 Drawing: Figure  
 Scale: 1:200000  
 Projection: UTM Zone 20 (NAD 83)



- |                                |                              |
|--------------------------------|------------------------------|
| <b>Mesozoic</b>                | <b>Devonian</b>              |
| Sedimentary and Volcanic Rocks | Granitoids                   |
| <b>Carboniferous</b>           | <b>Cambrian - Ordovician</b> |
| Cumberland Group               | <b>Meguma Supergroup</b>     |
| Windsor Group                  | Halifax Group                |
| Horton Group                   | Goldenville Group            |



**Figure 2**  
Licence Location Map  
Brookfield, NS

Date: 9/8/2012  
Author: AS  
Office: Acadian  
Drawing: Figure

Scale: 1:100000 Projection: UTM Zone 20 (NAD 83)



Road	—	Acadian Mining License	□
Highway	—	Other Licence Holder	▨
Railway	—		
River	—		
Water Body	—		

### 3.0 Licence Tabulation

Licence 09752 consists of 21 mineral exploration claims in total. Upon review of the property Annapolis will renew this licence in full. See Table 1 below.

Licence	NTS Map	Tract	Claims
09752	21 A 07 C	32	EFLO
	21 A 07 C	33	ABCD EFGH LMP
	21 A 07 C	40	ABH
	21 A 07 C	41	CDE

Table 1: Claims tabulation for licence 09752 Brookfield Mines.

### 4.0 Climate and Physiography

Southwestern Nova Scotia is characterized by northern temperate zone climatic conditions moderated by proximity to the Atlantic Ocean. Seasonal variations occur, with winter conditions of freezing and/or substantial snowfall expected from late November through late March. Spring and fall seasons are cool, with frequent periods of rain. Summer conditions can be expected to prevail from late June through early September with modest rainfall and daily mean temperatures in the 15 to 20 degrees Celsius range. Maximum daily summer temperatures to 30 degrees Celsius occur, with winter minimums in the minus 25 to minus 30 degrees Celsius range.

Topography is relatively flat in this area with relief not more than 15m. The vegetation is characterized as mostly mixed, mature forest with a large swamp to the southwest, which resulted from the damming of Meadow Brook during early mining operations.

### 5.0 Previous Work

The Annapolis claims surround the main Brookfield gold district, which was the focus of the majority of historical work. Mining commenced in this area in 1886, a year after gold was first discovered here and was continuous until 1906 and then intermittently to 1928. Historic production figures for the period between 1887 and 1922 show 42 251 ounces of gold were extracted from 102 339 tons of ore crushed (Kennedy, 2006). The district was mapped at a scale of 1:30 000 by E.R. Faribault in 1909.

The Libbey Vein, which was mined extensively, occurs within the main district. Ore shoots are defined by the intersection of three bedding parallel quartz vein/ slate zones:

the Mill, Stockman and Jim Leads, with the steeply dipping Libbey Fissure (74°, avg. thickness 0.28 m). Similar ore shoots were mined periodically from 1905 – 1935 are also located on this property, occurring between the King Fissure (average thickness 0.52m) and King Streak veins intersection with bedding parallel veins (Fig. 3).

The East Mine Fissure with an average thickness of 0.3m was mined sporadically from 1905-1935, but specific historical production is not available for it. Little information is available on the numerous pits and small shafts sunk on various bedding parallel veins in the area during this period.

Exploration has been intermittent from 1935 to present. Several geophysical and diamond drilling programs have been carried out with the main focus being the Libbey and King Fissure areas.

1948: Marshall Red Lake Mines Ltd. completed a self-potential survey run over most of the property. A total of 14 anomalies were identified and of these they followed up with diamond drilling on two anomalous zones the following year. Seven holes were drilled with a total meterage of 365m, but core descriptions are vague and no assay data is available.

1963-1965: Marimac Mines Ltd conducted a reconnaissance magnetometer survey over the Libbey and East veins to try and locate potential quartz bearing slate zones. 1737m was drilled in 31 holes. The majority of the hole targets were designed to test the eastern extent of the Libbey vein. All of these holes were situated on the central Brookfield area.

1974: Dominion Jubilee Corporation cut a grid and ran EM-16 and magnetometer surveys on the property, as well as digging some test pits to test tailings in the area. They also carried out limited mapping in the local area and found low grade arsenopyrite in auriferous metasandstone. Allan Frew, the geologist responsible for the mapping was critical of Faribault's mapping, suggesting that in many instances schistosity had been mistaken for bedding. He made the interpretation that more local, intermediate scale folding occurred. However he made very few bedding measurements himself. This was probably due to the fact that the dominant geology is easily cleaved, fine grained, muddy metasandstone. More recent mapping encountered similar problems in locating good bedding indicators.

1976-1984: An extensive VLF-EM survey and a more focused self-potential survey were carried out by Maritime Exploration Syndicate (MEX). In 1981, 24 shallow holes on geophysical anomalies, two of which were drilled on this licence. A total of 1376 m were drilled. MEX also carried out some trenching on the Mill and Stockmen leads.

1985: Tri- Exploration prospected areas of anomalous values as indicated by the 1948 self-potential survey and took large grab samples along the railway and thus named the Railway Showing (Dawe, 1986).

1987: Falconbridge carried out mapping, lithochemical sampling, and further grid emplacement, IP gradient, resistivity and self-potential surveys in this area. They also drilled 8 diamond drill holes with a total of 1013m of core, which was assayed extensively (Jensen, 1987). They subsequently drilled 4 test holes on IP anomalous zones and made a stratigraphic correlation across the area tested.

1993-95: Abacus Mineral Corporation carried out mapping, trenching, and biogeochemical sampling as well as till, soil and rock sampling on this claim block (Graves, 1993). They also carried out diamond drilling to the north.

1993: The Nova Scotia Department of Natural Resources carried out a Mineralogical Study on mineral-rich metasandstone from North Brookfield.

1991-1995: Gold Bank Resources, funded partially under the Mineral Investment Stimulation program and ACOA, carried out an assessment of tailings from the King Mine site. The tailings from the King Mine site were selected for the assessment because it is of the highest grade in the Brookfield area (MacDougall, 1995). During the fall of 1991 and spring of 1992, tailings at the King Mine site were prepared for bulk testing through earthwork construction, access road improvement, work site preparation and sample testing. In the summer and fall of 1992, testing of potential components of a portable mill to process the tailings was undertaken and a mill was designed. In 1993 a full-scale portable mill was constructed at the King Mine site and a series of bulk tests on the remaining King Mine tailings and waste rock was carried out. A total of 646.6 tonnes of tailings and waste rock were processed from the King Mine before the site was decommissioned and reclaimed at the end of 1994.

1997: The Nova Scotia Department of Natural Resources drilled a diamond drill hole on the western portion of the property but it was never sampled.

1999: Lyndon Jensen did some intensive prospecting, mapping, till sampling and a biogeochemical survey collecting 51 samples and assaying 36 (Jensen, 1999). The results were insignificant and no further work was carried out.

2005: Mercator Geological Services carried out a field study of primarily prospecting and sampling, from which four anomalous quartz veins ranging in 1.11g/t – 1.45 g/t Au. The

anomalous results reflected sampling from the old mine workings and quartz float that was found in the proximity.

2006: Another field study was conducted by Mercator Geological Services, this time for Acadian Gold Corporation. The field study included outcrop and float sampling as well as a ground magnetic survey. Rock sampling identified promising results in areas proximal to old mine workings. The magnetic survey failed to produce any significant highs in the data set.

2008: Acadian Mining Corporation carried out a field program at North Brookfield in which consisted of geological mapping, rock sampling and the collection of several till samples for the purpose of a gold grain study. Due to good bedrock exposure on the property, geological mapping was successful in confirming information presented by Faribault (1908). Till samples and rock samples returned some anomalous results, however most are associated with areas of known high grade mineralization from quartz veins.

## 6.0 Regional Geology

The Meguma Terrane of south eastern mainland Nova Scotia is underlain by folded Cambro-Ordovician age sedimentary sequences of the Meguma Supergroup and extensive areas of Mid-Devonian granitoids. The Meguma Supergroup comprises two groups, namely the greywacke-dominated Goldenville Group and the overlying slate-argillite dominated Halifax Group, each of which has been subdivided into Formations (e.g. White et al., 2007; Horne and Pelley, 2007).

The Meguma Supergroup was deformed during the mid-Devonian Annapolis Orogeny resulting in east to northeast trending regional folds and associated axial planar cleavage. Regional folds typically show upright to overturned geometry and are frequently doubly plunging at shallow angles resulting in elongate domal structures.

Metamorphism associated with the Annapolis Orogeny varies across the Meguma Terrane from amphibolite facies in the extreme northeast and southwest areas. The central mainland is characterized by mid or lower greenschist facies assemblages. Large volumes of granite and granodiorite were intruded into the folded and metamorphosed Meguma Group during mid-Devonian to early Carboniferous time, resulting in development of well defined contact aureoles. Lower Carboniferous and younger aged strata unconformably overlie the eroded Meguma surface and have been affected by folding and shearing. Northwest trending faults typically showing sinistral strike-slip separation are common throughout the Meguma Terrane

### 6.1 Goldenville Group

The Goldenville Group, which forms the basal unit of the Meguma Supergroup is host to most of the known gold deposits in the province. The group generally consists of intercalated metagreywacke and metasilstone (Malcom, 1976; Schenk, 1978). On the eastern shore the goldenville group generally consists of repeated turbiditic cycles consisting of thick metagreywacke fining upwards to thin metasilstone and black slate caps. Mappable formations are locally recognized within the Goldenville Group (White, 2006; White et al., 2007; Horne and Pelley, 2007) although no subdivision has been made in the Upper Seal Harbour area.

### 6.2 Halifax Group

The Halifax Group forms the upper part of the Meguma Group and is generally comprised of thinly bedded slates and minor metasilstone and metasandstone (Malcolm, 1976). The Halifax Group has been locally subdivided into formations. The Cunard formation is regionally mappable and defines a stratigraphic marker within the Halifax Group. The Cunard Formation consists of fine-grained dark slates and interbedded metasandstone beds and hosts significant sulphide mineralization, mainly pyrite and pyrrhotite. The Cunard Formation is locally underlain by the Beaverbank Formation which consists of carbonate and manganese rich slates and

metasiltstone locally characterized by coticule layers (Horne and Pelley, 2007). The stratigraphically highest unit of the Halifax Group generally consists of grey-green metasiltstone and metasandstone lithologies. In the eastern shore area this unit is referred to as the Glen Brook Formation (Horne and Pelley, 2007).

## 7.0 Property Geology

The Brookfield area is covered with a relatively thin layer of glacial till consisting of a stony till plain facies and drumlin facies as described by Stea, et al. (1992). Thickness' varies from 2 – 20 m in the stony till plain and 4 – 30 m in the drumlin facies. Stony plain till facies is also distinct from the drumlin facies because it contains stony and sandy material derived from a local bedrock source, whereas drumlin facies contains a clay rich matrix as it has been incorporated material from an older glacial till.

Due to thin till cover on the Annapolis Licence there is considerable outcrop exposure, and the bedrock geology is quite well known. The Brookfield property is underlain by Goldenville strata, dominated by metasandstone with minor interbedded metasiltstones and slates. A 1:3000 map constructed by Fairbault (1908) indicates that a doubly plunging anticlinal dome crosses the center of the property running roughly NW-SE. The south and north limb of the anticline dip between 20 - 45° and 45 – 65° respectively, and the East and West axial plunges are approximately 25°. Also present in the area are two faults trending NW and E known to post-date the formation of the anticline as they are relatively unaffected by folding (Fig. 3).

High grade gold mineralization in the Brookfield area is associated with the intersection of bedding parallel and discordant quartz veining (Kennedy, 2006). The Libbey Fissure vein and East Mine Fissure vein in the northern region of the property, and the King Fissure Vein in the south are examples of zones of gold mineralization that have been mined historically. The steeply dipping Libbey Fissure vein, the source of the vast majority of gold production, is not located on an Acadian licence, but the East Mine Fissure and King Fissure are located on Acadian licences (06228 and 06240 respectively).

In the late 1980's low grade gold mineralization was found in metasandstones near the anticlinal hinge, and the broad area is known as the railway showing (Fig. 3). Abacus Mineral Corporation work in 1993 revealed gold mineralization (grading 1-2g Au) within an arsenopyrite and pyrite bearing sericitized metasandstone over 15 to 40 m stratigraphically thick zone extending at least 85m along strike and 100m in depth. One of the best sample intervals reported to date from this area graded 3.83 g/t over a 2.4m apparent width in one of Abacus' trenches (Weekes, et al., 1993). They also found that mineralization was most prevalent in metasandstones that had a

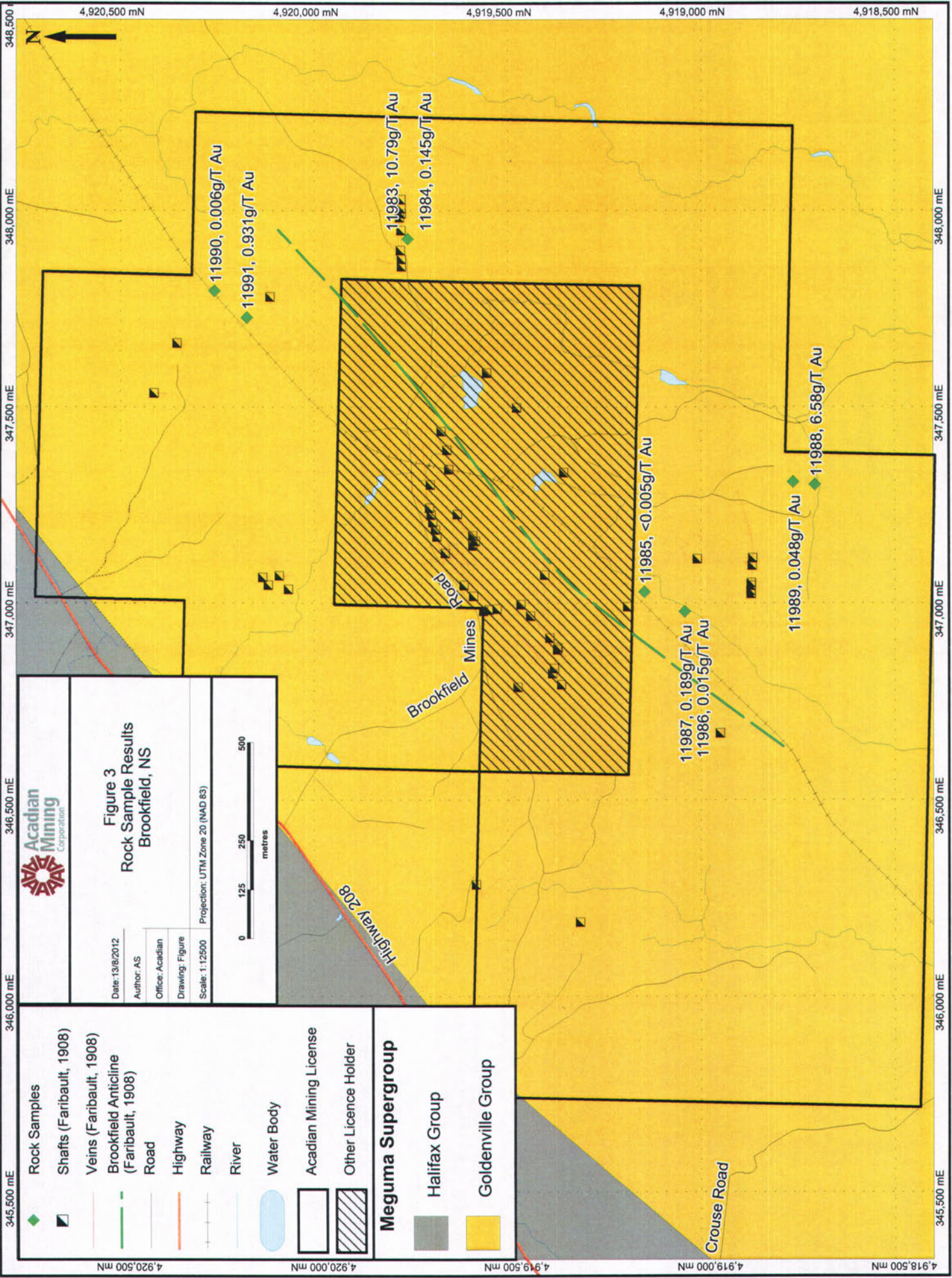

**Acadian Mining Corporation**

**Figure 3**  
Rock Sample Results  
Brookfield, NS

Date: 13/6/2012  
Author: AS  
Office: Acadian  
Drawing: Figure  
Scale: 1:12500  
Projection: UTM Zone 20 (NAD 83)

0 125 250 500 metres

	Rock Samples
	Shafts (Faribault, 1908)
	Veins (Faribault, 1908)
	Brookfield Anticline (Faribault, 1908)
	Road
	Highway
	Railway
	River
	Water Body
	Acadian Mining License
	Other Licence Holder
<b>Meguma Supergroup</b>	
	Halifax Group
	Goldenville Group

11983, 10.79g/T Au  
11984, 0.145g/T Au  
11990, 0.006g/T Au  
11991, 0.931g/T Au  
11985, <0.005g/T Au  
11987, 0.189g/T Au  
11986, 0.015g/T Au  
11988, 6.58g/T Au  
11989, 0.048g/T Au

Brookfield Mines  
Road

Highway 208

Crouse Road

345,500 mE 346,000 mE 346,500 mE 347,000 mE 347,500 mE 348,000 mE 348,500 mE

4,918,500 mN 4,919,000 mN 4,919,500 mN 4,920,000 mN 4,920,500 mN

sharp contact with overlying slate. Metasandstone with gold mineralization is commonly associated with sulphide mineralization, carbonate alteration, and silicification.

## 8.0 Work Performed

### 8.1 Rock Sampling

In 2012, Annapolis carried out a field program which consisted of the collection of nine rock samples. The samples consisted of material collected from glacial till and from clobbering piles adjacent to historic mine workings. The samples were collected in an attempt to identify different mineralized phases. Several samples of altered slate and/or metasandstone were collected in order to evaluate potential wall-rock mineralization possibly amenable to bulk style mining. Several samples representing quartz veins of various characters were collected, in order to identify which veins contain mineralization. The samples were sent to Dalhousie Universities Minerals Engineering Centre for assay. Upon arriving, the samples were dried, crushed, pulverized and processed by digestion in Aqua Regia and analyzed by Atomic Absorption Spectroscopy (AAS). Descriptions and assay results for the rock samples are shown below in Table 2. The locations of the samples are displayed on Figure 3.

Sample ID	East	North	Au (ppm)	Description
11983	347927	4919758	10.79	Composite quartz sample. Occasional slate and metasand selvages. Weak sulfide alteration. Quartz is opaque, white with dull to sugary lustre.
11984	347927	4919758	0.145	Chip sample of angular qtz/metasand. Moderate sulfide alteration. Abund euhedral sub-mm pyr xls and casts. Abund Fe stain. Occasional chlorite. Near Faribault shafts BRO 4 047 and 048, approx 20m west of previous.
11985	347028	4919146	<0.005	High C03 metasand cobble from sub-crop. Fissile, well cleaved, moderate Fe stain.
11986	346978	4919042	0.015	Pile of metamud/sand cobbles. Visible Bouma sequences, mud rip-ups in coarse sand overlying laminated metamuds. Heavy C03 and mica alteration in metasands. Metamuds show biotite porphs, sub-mm. Abund polished shear surfaces.
11987	346978	4919042	0.189	Cobble. Weakly altered, competent meta-sand. Rare sulfides. Qtz vein, vitreous, transparent, <1cm true thickness.
11988	347301	4918706	6.58	Composite sample. Material from waste pile. Black slate and quartz (as described in fieldnotes), with minor unaltered metasand.

11990	347795	4920257	0.006	Interbedded metamud/sand cobble, likely hinge. Strong FeCO <sub>3</sub> alteration.
11989	347308	4918762	0.048	Qtz vein float, represents 2 parallel qtz veins, 2cm and 3-4cm veins, with wall rock between. Wall rock is sugary metasand. Veins are laminated, glassy to milky, contain abund AsPy and Galena. Wall rock also contains abund AsPy porph's.
11991	347728	4920174	0.931	Sample of 6" qtz vein. Bully white with occasional chlorite, very little alteration.

Table 2: Descriptions and assay results for rock samples.

## 9.0 Discussion

The analytical results for rock samples collected from the Brookfield property indicate anomalous levels of gold in several samples. These results are encouraging and confirm mineralization extends from the main property to Acadian ground. Sample 11983 contained 10.79 ppm gold however this sample represents quartz vein material which was collected from waste piles near historic shafts so the anomalous grade is not surprising. Sample 11991 and 11988 contained .0931 and 6.58ppm respectively but were also collected from near historic mine workings. One sample of interest was 11986 which contained no noted quartz vein material but returned a marginally anomalous value of 0.015ppm Au.

Current exploration at Brookfield is focused on identifying potential bulk-minable mineralization. One sample of metasandstone / metamudstone contained marginally anomalous level of gold. This is encouraging and provides some evidence to the presence of wall rock mineralization which is considered to be a key characteristic in bulk-minable deposits.

## 10.0 Recommendations

Further sampling at Brookfield should focus on isolating different rock types (i.e. metasandstone, metamudstone, quartz veins) in order to better evaluate mineralization from each rock type. Ultimately diamond drilling should be carried out with the core being sampled over its entire length. Sampling of drill core should also focus on isolating different rock types.

## 11.0 References Cited and Selected References

**Dawe, J. E. 1986.** Gold, Brookfield Mines, Queens County, Nova Scotia. Report on Geology, Rock Sampling and Assays, Assessment Report ME 1986-72

**Faribault, E.R. 1908.** Brookfield Gold District, Queens County, Nova Scotia. Geologic Survey of Canada, map, scale 1 : 3000

**Goodwin, T.A. 2005.** Nova Scotia Gold Grain Study: Background and Anomalous Concentrations of Gold Grains in Till. In Mineral Resources Branch, Report of Activities 2004; Report ME 2005-1, p. 15-26.

**Goodwin, T.A. 2006.** Nova Scotia gold grain study: background and anomalous concentrations of gold grains in till from the Beaver Dam gold district (NTS 11E/02) and Hillsvale (11D/13) Areas. In Mineral Resources Branch, Report of Activities 2006; Report ME 2006-01, p. 55-65.

**Graves, M. C. 1993.** Gold, Brookfield Mines, Queens County, Nova Scotia. Report on rock sampling and assays, 1993 Assessment Report ME 1993-58

**Graves, M. C. 1995.** Gold, Brookfield Mines (North Brookfield), Queens County and West Gore, Hants County, Nova Scotia. Report on the testing of a Full Scale Gravity Mill for the Extraction of Gold from Mine Tailings and Mine Waste Rocks (Assessment Report, Special Licence #1/92), 1995 Assessment Report ME 1995-020

**Horne, R.J., and Pelley, D.E., 2007.** Geological Transect of the Meguma Terrane from Centre Musquodoboit to Tangier. In NSDNR Report ME 2006-1 p71-89.

**Jensen, L. R. 1987.** Gold, Brookfield Mines, Queens County, Nova Scotia. Report on an IP Survey, 1987 Assessment Report ME 1987-248

**Jensen, L. R. 1987.** Gold, Brookfield Mines, Queens County, Nova Scotia. Report on magnetic and VLF-EM surveys, 1987 Assessment Report ME 1987-122

**Jensen, L. R. 1999.** Gold, Brookfield Mines, Queens County, Nova Scotia. Report on Prospecting, Geological Mapping, Rock Sampling and Chemical Analyses, a Spruce Bark Geochemical Survey, a Till Sampling Survey, and Gold Planning, 1999 Assessment Report ME 1999-076

- King, M.S. and Webster, P. 1997:** Report of work, First Teat Assessment, RJZ Mining Inc. Meguma Gold Project, Eastern Shore Claim Group. Nova Scotia Department of Natural Resources Assessment Report 97118.
- MacGregor, R.A. 1930:** History of the Fifteen Mile Stream Gold Mine. NSDM open file report 432161
- Malcolm, W. 1976:** Goldfields of Nova Scotia, GSC, Memoir 385, 253 p.
- Schenk, P.E. 1978:** Synthesis of the Canadian Appalachians. IGCP Project 27, Caledonian-Appalachian Orogen of the North Atlantic Region, Geol. Surv. Can. Pap. 78-13, 111-136.
- Stea, R.R., Conley, H. and Brown, Y. 1992:** Surficial Geology Map of the Province of Nova Scotia, 1:500 000. Nova Scotia Department of Natural Resources Map ME 1992-3
- White, C. E. 2006:** Preliminary Bedrock Geology of the Liverpool and Lake Rossignol Map Areas NTS 21A/02 and 21A/03), Southern Nova Scotia. *In* Mineral Resources Branch, Report of Activities 2005; Report ME 2006-1, p. 149-163.
- White C.E., R.J. Horne, and S.M. Barr 2007:** The Meguma Group of southern Nova Scotia: new insights on the stratigraphy, tectonic setting, and provenance. In Programs and abstracts; Atlantic Geoscience Society Colloquium & Annual General Meeting.

**Appendix I: Statement of Qualifications****Drew Pelley**

I am Drew Pelley, of Dartmouth, Nova Scotia, and hereby certify that:

1. I am a Geologist employed by Annapolis Properties Corporation, located in Halifax, Nova Scotia.
2. I am a graduate of Dalhousie University, from which I received a Bachelor of Science degree in Earth Sciences in 2007.
3. I have actively worked as an exploration geologist since 2006 in Nova Scotia, gaining experience in a variety of gold and base metal deposits. My experience includes, but is not limited to, various geochemical exploration techniques, core logging, and field-mapping.
4. The accompanying report is based on the study of the referenced geological, geophysical, and geochemical reports and maps, for the study area and surrounding areas in addition to extensive field work performed in the study area.
5. The conclusions reached in this report are based, in part, on the interpretation of previously acquired data believed to be accurate and correct. Existing data has been interpreted in conjunction with the extensive original exploratory work described herein.

July, 2012.

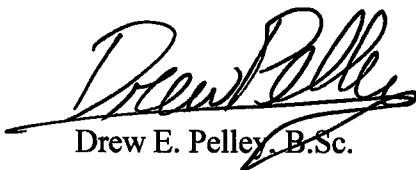

Drew E. Pelley, B.Sc.

**Appendix II: List of Personnel**

Annapolis Properties Personnel

Tyler Compton..... Project Geologist  
Drew Pelley.....Project Geologist  
Richard Horne.....Chief Geologist  
Adam Sherry.....GIS Analyst

Laboratory Analysis

Dalhousie University, Minerals Engineering Centre

**Appendix III: Original Laboratory Certificates**

17-Aug-12

Acadian Mining Corporation  
10 Morris Drive, Unit 6  
Dartmouth, NS  
B3B 1K8  
Attn: Drew Pelley

minerals.engineering.dal.ca  
Tel: 902.494.3955  
Fax: 902.494.3506  
Email: mec@dal.ca

Re: Results of analysis on submitted samples. Au analysis  
using 30g FA-lead collection, AAS or ICP OES finish.

Sample	ppm
	Au
11983	10.79
11984	0.145
11985	<0.005
11986	0.015
11987	0.189
11988	6.58
11988 Lab Dup.	5.58
11989	0.048
11990	0.006
11991	0.931

Certified Reference Samples:	Au ppm	
	Measured	Expected
OXC72	0.208	0.205±0.003



Digitally signed by  
Daniel Chevalier  
Date: 2012.08.16  
16:05:03 -03'00'

Daniel Chevalier, MASC  
Manager, Minerals Engineering Centre

## Fire Assay Procedure – Gold

Sample Decomposition: Fire Assay Fusion  
Analytical Method: Atomic Absorption Spectroscopy (AAS), Inductively Coupled  
Plasma Optical Emission Spectroscopy (ICPOES)

A prepared sample is fused with a neutral lead oxide flux inquartered with 4 mg of gold-free silver and then cupelled to yield a precious metal bead. The bead is digested for one hour in 1.0ml of dilute nitric acid. Hydrochloric acid (1.0ml) is then added and the solution is digested for an additional hour. The digested solution is then cooled, diluted to 6.0 ml with double distilled water, mixed and then analyzed by AAS or ICPOES.

Certified reference samples from CANMET, West Coast Minerals, or Rocklabs are analyzed with each batch. In addition, duplicate check analysis and method blank analysis are also run with the samples. A CRM sample is inserted with every batch of 20 samples.

Au detection limit is 0.005 ppm, or 5 ppb, on a 30g sample.

*Interim*

*Brookfield 4752  
July 8 2002*

**NOVA SCOTIA**  
Natural Resources

Map 11A7C  
Refs. \_\_\_\_\_

**Form 10 - Statement of Assessment Work Expenditure**  
(pursuant to the *Mineral Resources Act*, S.N.S. 1990, c. 18, s. 43(1))

(Complete as necessary to substantiate the total claimed.)

Re: Licence No. 09752 Date of issue July 8, 2002

Type of Work		Amount Spent
1.	Prospecting _____ days	
2.	Geological mapping _____ days	
3.	Trenching/stripping/refilling _____ m <sup>2</sup> / _____ m <sup>3</sup>	
4.	Assaying & whole rock analysis _____ #	
5.	Other laboratory _____ #	
6.	Grid: (a) Line cutting (b) Picket setting (c) Flagging	_____ km _____ km _____ km
7.	Geophysical surveys Airborne: (a) EM/VLF (b) Mag or Grad (c) Radiometric (d) Combination (e) Other _____	_____ km _____ km _____ km _____ km _____ km
8.	Geophysical surveys Ground: (a) EM/VLF (b) Seismic soundings (c) Magnetic/telluric (d) IP/resistivity (e) Gravity (f) Other _____	_____ km _____ # _____ km _____ km _____ km _____ km
9.	Geochemical surveys (a) Lake, stream, spring (i) Water (ii) Sediments (b) (i) Rock (ii) Core (iii) Chips (c) (i) Soil (ii) Overburden (d) Gas (e) Biogeochemistry (f) Sample collection (g) Other _____	_____ samples _____ samples _____ samples _____ samples 4 _____ samples _____ samples _____ samples _____ samples _____ samples _____ days _____ #
10.	Drilling: (a) Diamond (# holes/m) (b) Percussion (# holes/m) (c) Rotary (# holes/m) (d) Auger (# holes/m) (e) Reverse circulation (# holes/m) (f) Logging, supervision, etc. (g) Sealing (# holes)	_____ / _____ m _____ / _____ m _____ / _____ m _____ / _____ m _____ / _____ m _____ days _____ #
11.	Other (describe) <i>Report writing, maps</i>	_____
	Subtotal	2000
<b>Overhead costs</b>		
12.	Secretarial services	
13.	Drafting services	
14.	Office expenses (rent, heat, light, etc.)	1000
15.	Field supplies	
16.	Compensation paid to landowners	
17.	Legal fees	
18.	Other (describe)	
	Subtotal	1000
	Grand total	4000

*2 people x 2*

*400*

*1000*

