

PLAN OF 40 FOOT LEVEL,
HOLMAN GOLD MINE
CARIBOU GOLD MINES.

NOVA SCOTIA
SCALE 1 IN = 8 FT
B.W. HILLS, SURVEYOR

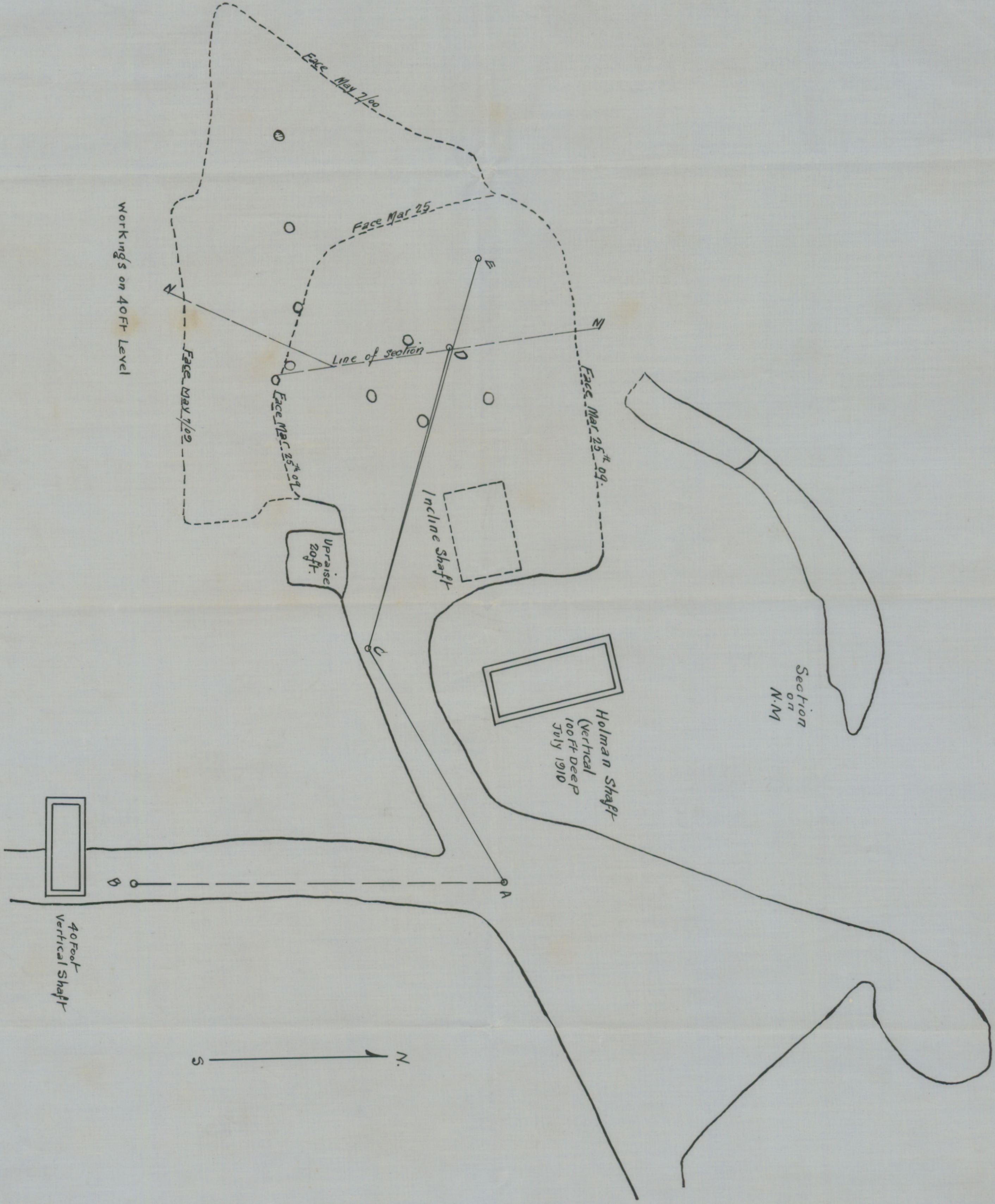

Workings on 40ft Level

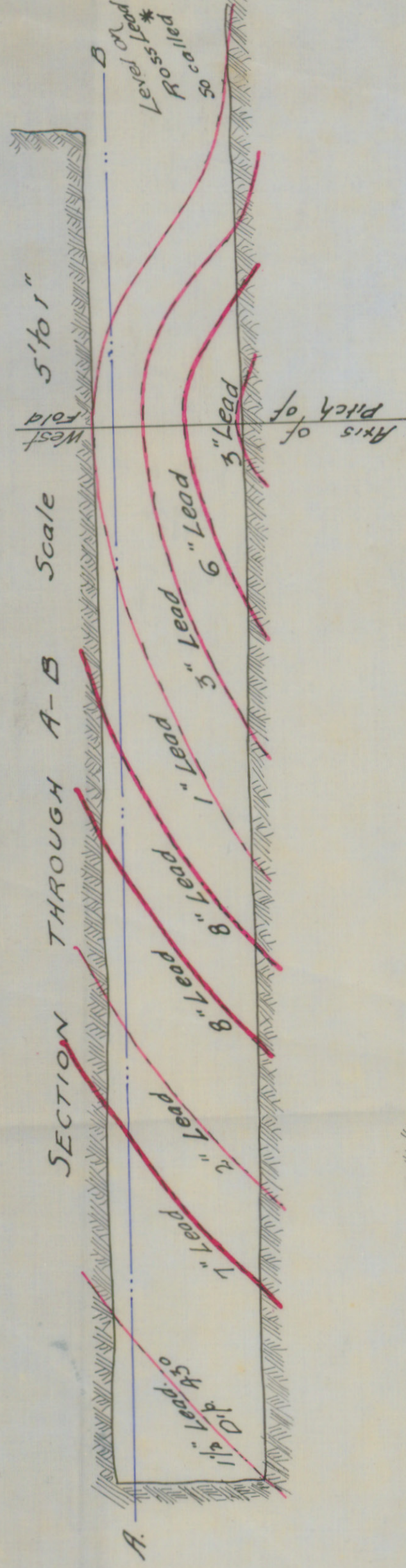

Note
* Rich strike found near fall of 1909

PLAN OF LEVEL CROSS CUTS.
Scale 20' to 1"

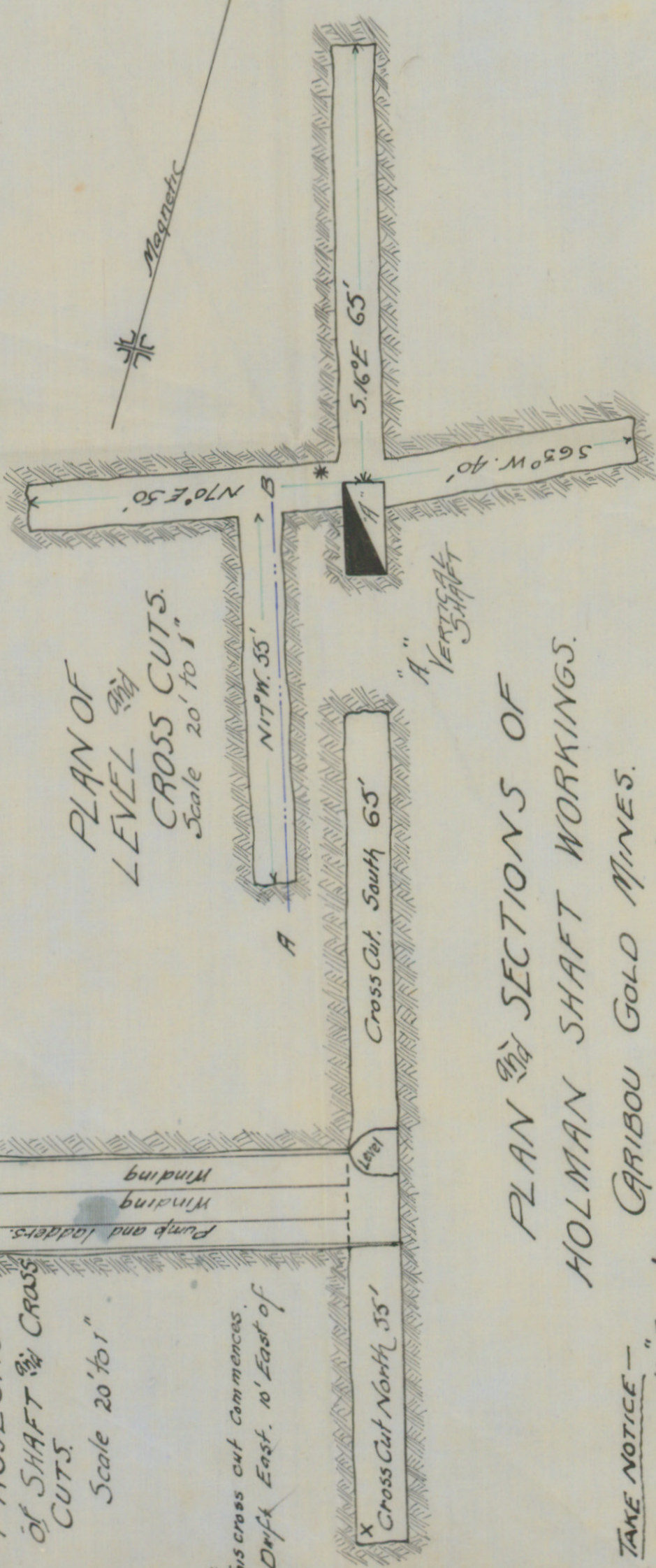

X Note
This cross cut commences from Drift East, to East of shaft.

PLAN OF SECTIONS OF
HOLMAN SHAFT WORKINGS.

CARIBOU GOLD MINES.
CARIBOU N.S.

- TAKE NOTICE -
Surveyed with Brunton
Pocket Transit, therefore
only closely approximate.

A.B. Peppers
- Oct. 18/1910 -