

LOCATION MAP

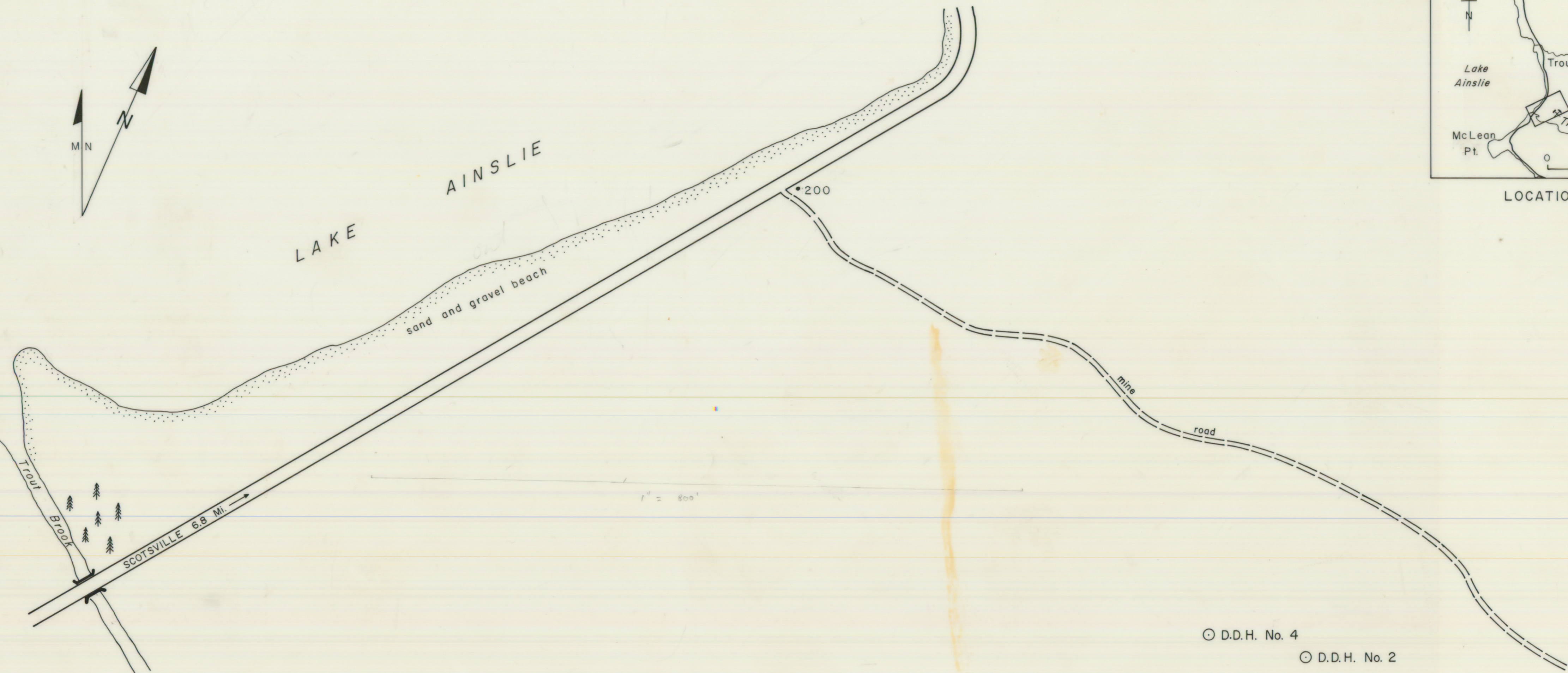

1" = 800'

⊙ D.D.H. No. 4

⊙ D.D.H. No. 2

⊙ D.D.H. No. 3

274•

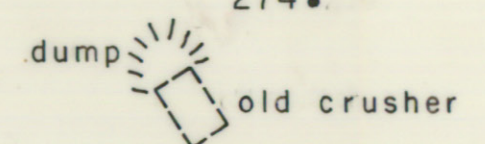

MacKay-Evans Mine (abandoned)

300•

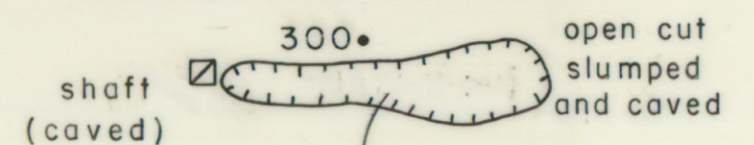

(CB74-K-1-1)

CAPE BRETON  
 MINERAL RESOURCES SURVEY  
 BARITE OCCURRENCE  
 Lake Ainslie Area, Inverness Co., N.S.

100 50 0 100 200  
 FEET

PLANE TABLED 1974 - D. KAVANAGH

⊙ D.D.H. No. 5