

SURFACE COVER TYPES

OFM 80-019

PEATLAND AREA

U7

PROVINCE OF NOVA SCOTIA
DEPARTMENT OF MINES AND ENERGY
1980

Scale - 1:10,000

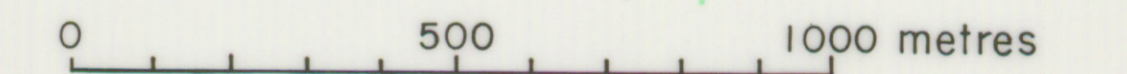

LEGEND

- Limit of bog
- Drainage channel and flow direction
- Pond or lake
- Survey line designation and length..... 800 N + 320E
- Poor road or trail.....
- Sample location
- Survey site
- Cover type boundary.....

COVER TYPE KEY

- B = Bog
- S = Sphagnum
- G = Graminoid
- LS = Low Shrub
- HS = High Shrub
- eg. GB = Graminoid Bog
- GF = Graminoid Fen
- F = Fen
- T = Treed
- GT = Graminoid treed
- ST = Shrub Rich treed
- HT = Hardwood treed
- CT = Conifer treed
- MT = Mixed treed

Bog	Total	≥ 1m deep	
	Area (ha)	Area (ha)	Volume (Million m ³)
U7 I2	168	107	2.17

A joint project of the Nova Scotia Department of Mines & Energy and the Canada Department of Regional Economic Expansion.

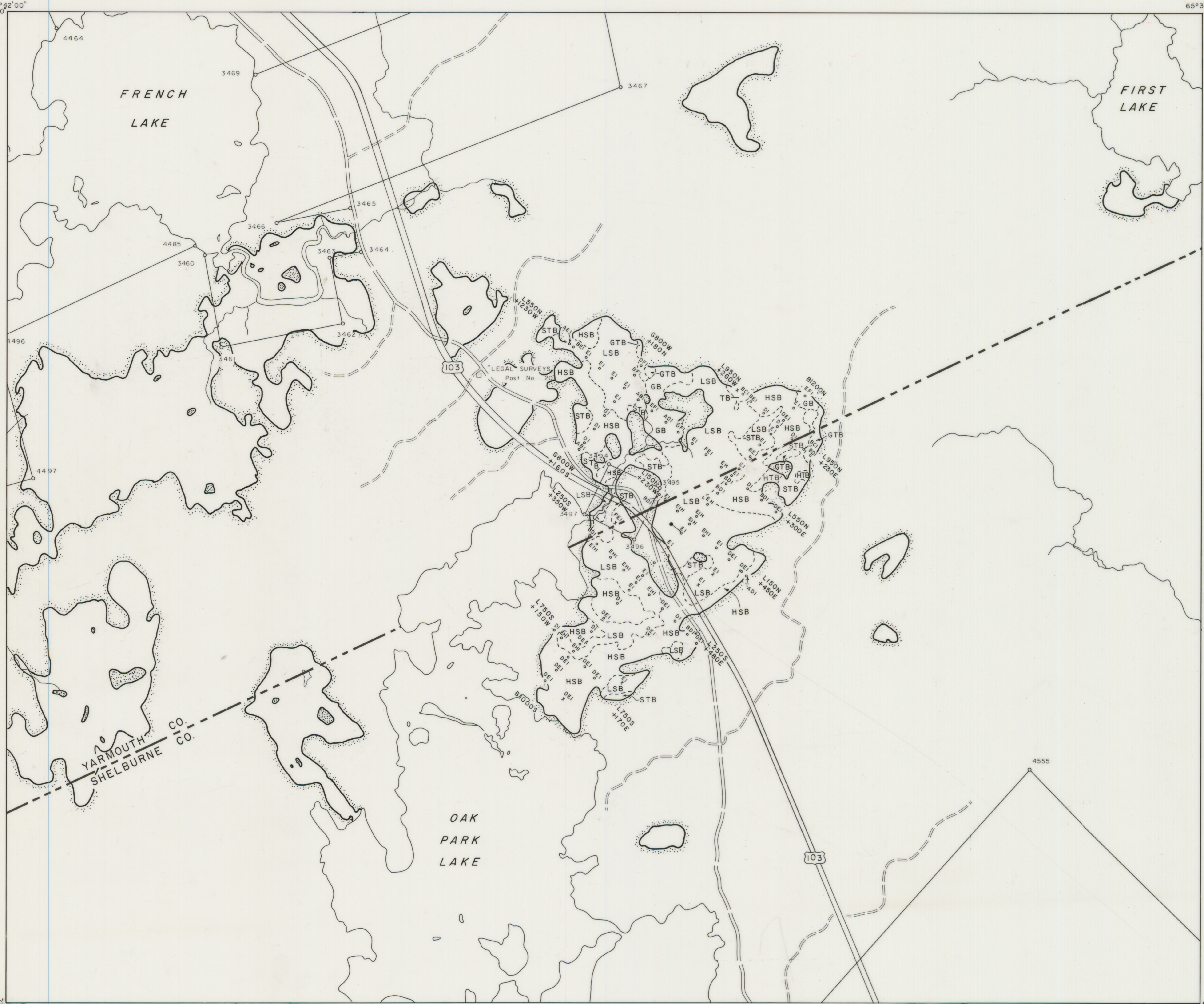
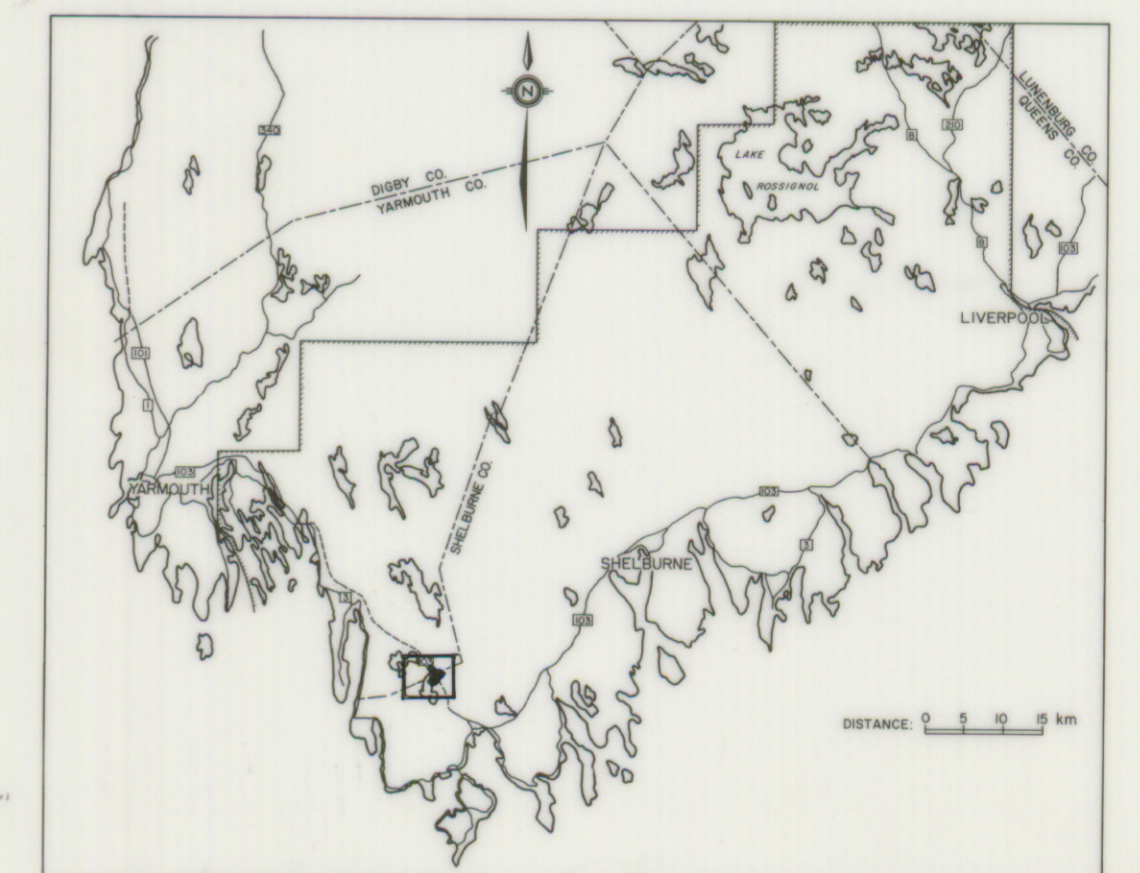

65°42'00"
43°39'00"

65°37'00"
43°39'00"

43°36'00"
65°42'00"
65 42 00

43°36'00"
65°37'00"