

- NOTES
- 1. TOTAL CATCHMENT AREA IS 41.7Ha. ONLY 3.5Ha OF SAID CATCHMENT AREA WILL BE ALTERED
 - 2. SEE SURFACE WATER MANAGEMENT PLAN DETAILS FOR CROSS SECTION OF BERM TO SURROUND EXTRACTION AREA

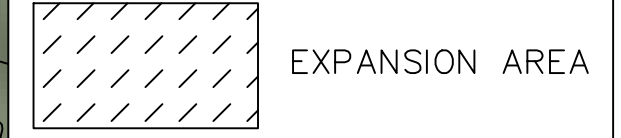

EXISTING SEDIMENTATION PONDS

20m X 30m
SEDIMENTATION POND
3H:1V SIDE SLOPES
BOTTOM ELE. = 112.5

DIVERSION SWALE
SLOPE = 1.1%

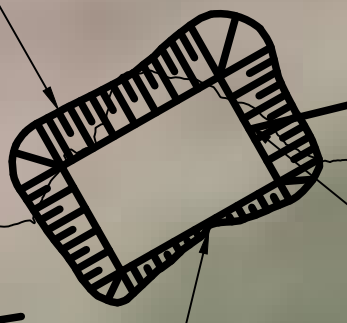

DRAINAGE DITCH
INLET ELE. = 114.5m

DITCH SLOPE = 1.5%

DRAINAGE DITCH
OUTLET ELE. = 112.5m

POND OUTLET

WC#2



PROJECT
SIX MILE BROOK ENVIRONMENTAL
ASSESSMENT

DRAWING
SURFACE WATER MANAGEMENT
PLAN

DRAWN	CHECK	SCALE
KM	SW	1:1250

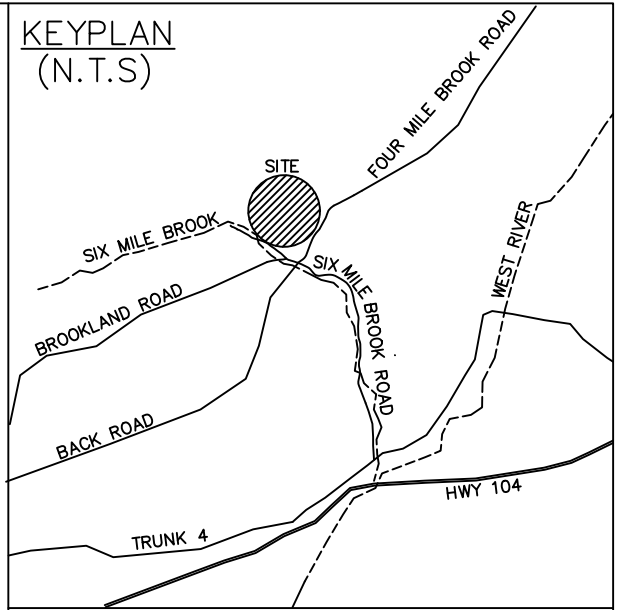

NOTES

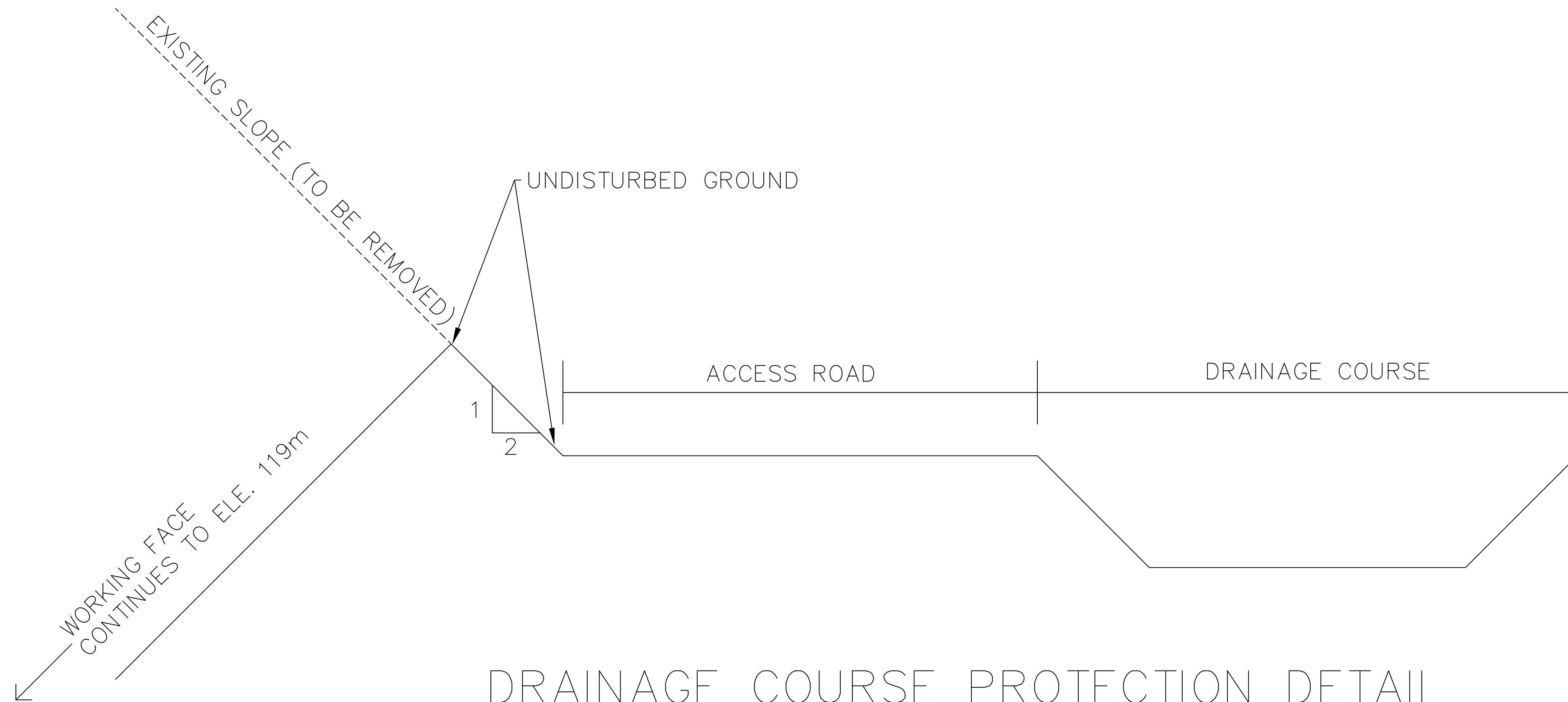

DRAINAGE COURSE PROTECTION DETAIL

(NTS)

1. 2m TALL EARTH BERM TO REMAIN AT EDGE OF ACCESS ROAD TO PREVENT SURFACE WATER DRAINAGE FROM ENTERING WORKING FACE

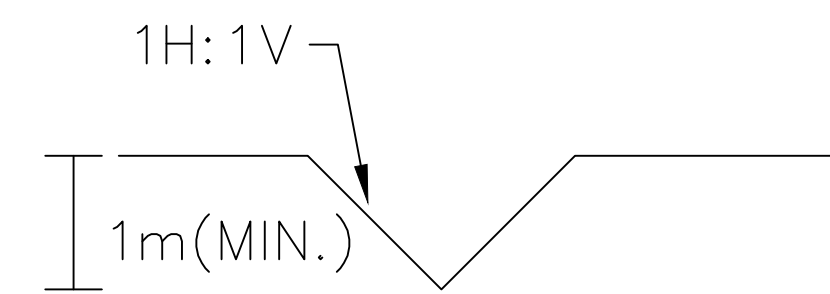

DITCH DETAIL

(NTS)



PROJECT
SIX MILE BROOK ENVIRONMENTAL ASSESSMENT

DRAWING
SURFACE WATER MANAGEMENT DETAILS

DRAWN	CHECK	SCALE
KM	SW	N/A